



## 26 Northampton Crescent ELIZABETH EAST SA

3 1 2

\*For an in-depth look at this home, please click on the 3D tour for a virtual walk-through\*

Virtual Tour Link:  
<https://my.matterport.com/show/?m=4wvtnsvwRPt>

To submit an offer, please copy and paste this link into your browser: <https://airtable.com/shrBb12PXtTjyZAXm>

Mike Lao and Edge Realty are proud to present to the market this beautifully renovated home, ready and waiting for you to move in and enjoy. The functional floorplan with two living areas will appeal to families craving contemporary comfort while investors will be drawn to the prime location and easy-care appeal of this impressive abode.

Updated timber look vinyl flooring flows throughout the

**Price** : \$ 200,000  
**Building Size** : 81 sqm  
**Land Size** : 561 sqm  
**View** : <https://www.edgerealty.com.au/sale/sa/north-north-east-suburbs/elizabeth-east/residential/house/6453758>



**Mike Lao**  
0410390250



**Corey Wilkop**  
0447888444

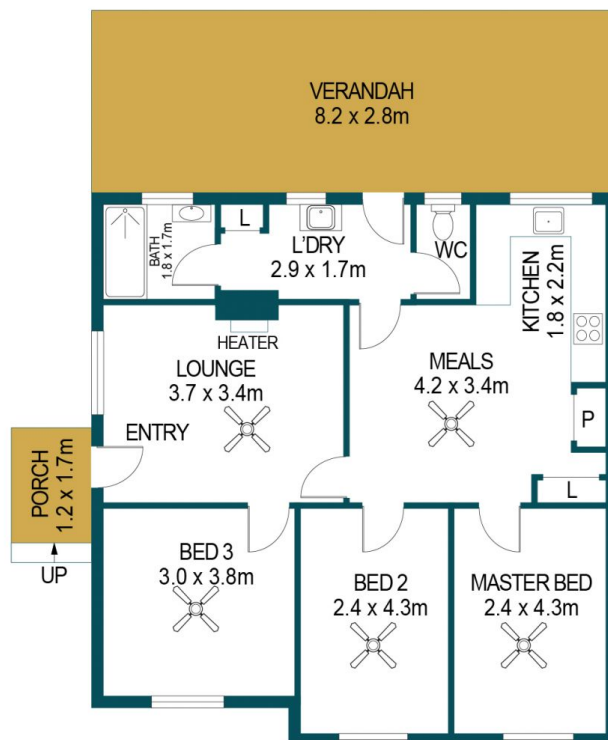
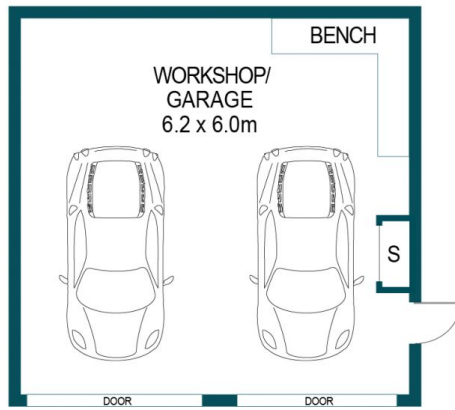

APPROXIMATE DIMENSIONS

LIVING:	81.1m <sup>2</sup>
PORCH:	2.0m <sup>2</sup>
VERANDAH:	22.9m <sup>2</sup>
GARAGE:	37.2m <sup>2</sup>
TOTAL:	143.2m <sup>2</sup>

## 26 NORTHAMPTON CRESCENT, ELIZABETH EAST

DISCLAIMER

PLANS SHOWN ARE FOR MARKETING PURPOSES ONLY, ALL DIMENSIONS ARE APPROXIMATE AND NOT TO SCALE. THEY ARE SUBJECT TO ERRORS AND INACCURACIES AND NO LIABILITY WILL BE ACCEPTED. INTERESTED PARTIES SHOULD MAKE THEIR OWN ENQUIRIES.



IMAGES AND FLOORPLAN BY:  
**IN-HOUSE**  
IMAGING  
inhouseimaging.com.au