



## 1 Trevalsa Court SALISBURY HEIGHTS SA

3 1 1

\*For an in-depth look at this home, please click on the 3D tour for a virtual walk-through\*

Virtual Tour Link:  
<https://my.matterport.com/show/?m=aTLBiUb6ocf>

To submit an offer, please copy and paste this link into your browser: <https://airtable.com/shrBb12PXtTjyZAXm>

Matt Ashford and Edge Realty are proud to present to the market this easy-care family home set on an expansive corner block and brimming with potential. The three-bedroom, one-bathroom layout is ready for the new owners to move in and enjoy plus there's plenty of room to make your own updates and add your personal style to the property.

The open-plan kitchen, meals and family zone is set in the

**Price** : \$ 320,000  
**Building Size** : 130 sqm  
**Land Size** : 561 sqm  
**View** : <https://www.edgerealty.com.au/sale/sa/north-north-east-suburbs/salisbury-heights/residential/house/6453780>



**Matt Ashford**  
**0487888178**

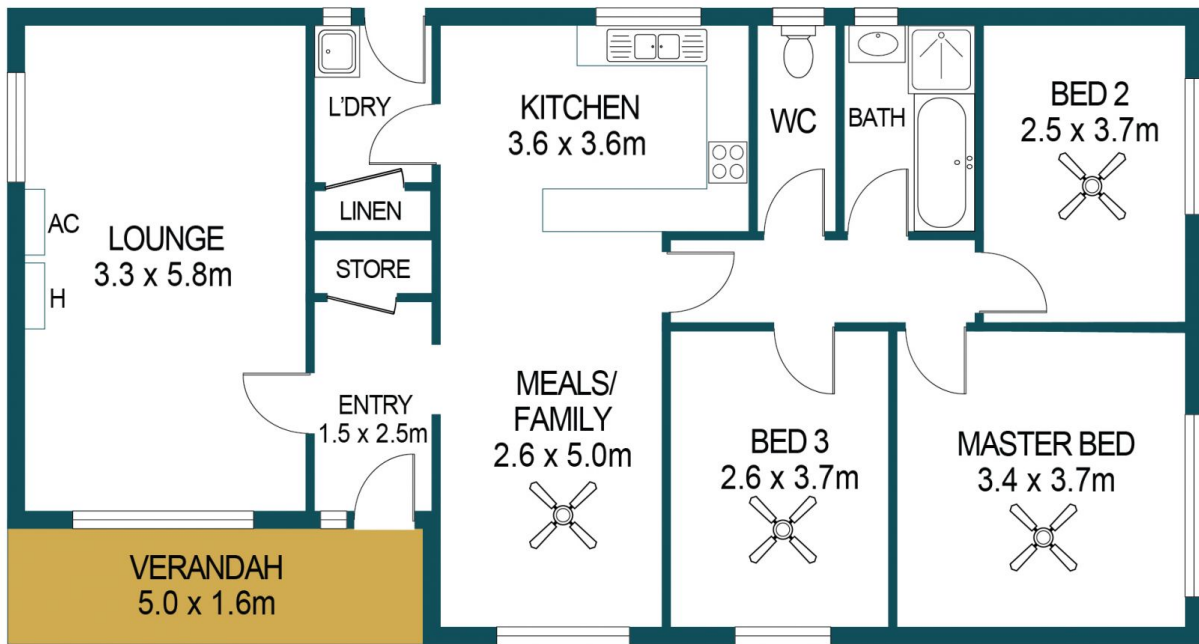
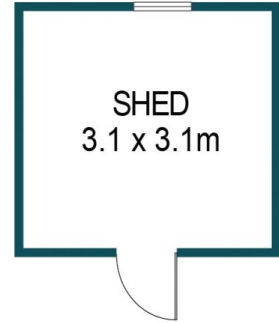
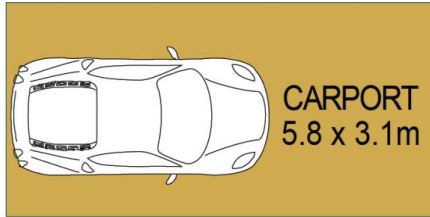

APPROXIMATE DIMENSIONS	
LIVING:	95.4m <sup>2</sup>
CARPORT:	17.9m <sup>2</sup>
SHED:	9.6m <sup>2</sup>
VERANDAH:	8.0m <sup>2</sup>
TOTAL:	130.9m <sup>2</sup>

## 1 TREVALSA COURT, SALISBURY HEIGHTS

### DISCLAIMER

PLANS SHOWN ARE FOR MARKETING PURPOSES ONLY, ALL DIMENSIONS ARE APPROXIMATE AND NOT TO SCALE. THEY ARE SUBJECT TO ERRORS AND INACCURACIES AND NO LIABILITY WILL BE ACCEPTED. INTERESTED PARTIES SHOULD MAKE THEIR OWN ENQUIRIES.



IMAGES AND FLOORPLAN BY:  
**IN-HOUSE**  
IMAGING  
inhouseimaging.com.au