



### 31 Salerno Court ELIZABETH EAST SA

3  1  1 

\*For an in-depth look at this home, please click on the 3D tour for a virtual walk-through\*

Virtual Tour Link:  
<https://my.matterport.com/show/?m=qP4gmZaRLgr>

To submit an offer, please copy and paste this link into your browser: <https://airtable.com/shrBb12PXtTjyZAXm>

Mike Lao and Edge Realty are proud to present to the market this easy-care home that will delight first-time buyers, young families and eagle-eyed investors alike. The quiet cul-de-sac location and quaint red brick facade add immediate appeal to this delightful home while inside, there's plenty of potential to add your own touches.

The layout is functional and easy-care with three good-size bedrooms all enjoying quick access to the central

**Price** : \$ 245,000  
**Building Size** : 86 sqm  
**Land Size** : 630 sqm  
**View** : <https://www.edgerealty.com.au/sale/sa/north-north-east-suburbs/elizabeth-east/residential/house/6453803>



**Mike Lao**  
0410390250



**Stephen Legierski**  
0438888114

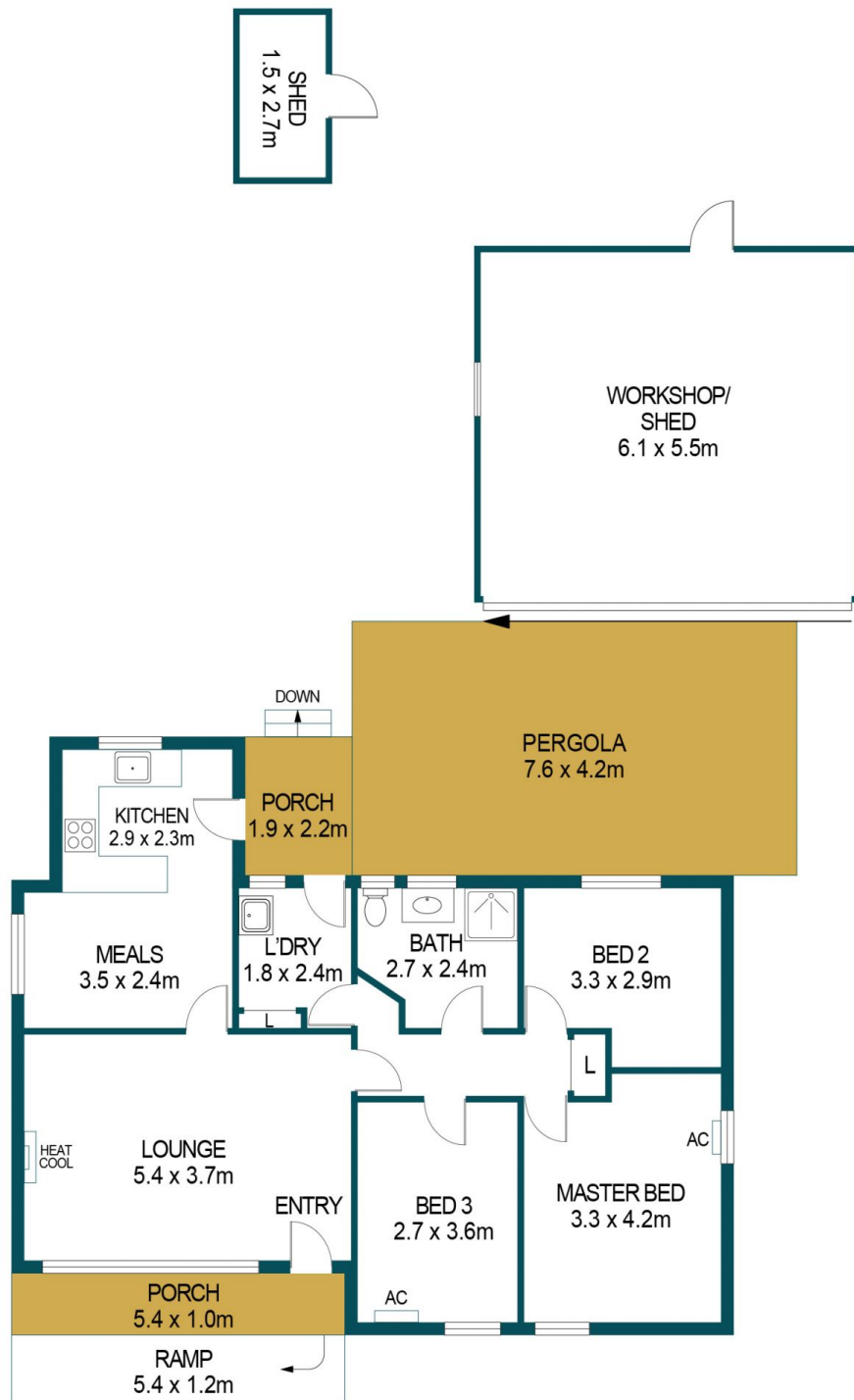

## 31 SALERNO COURT, ELIZABETH EAST

### APPROXIMATE DIMENSIONS

LIVING:	86.3m <sup>2</sup>
SHED:	37.6m <sup>2</sup>
PORCH:	9.6m <sup>2</sup>
PERGOLA:	31.9m <sup>2</sup>
TOTAL:	164.4m <sup>2</sup>

### DISCLAIMER

PLANS SHOWN ARE FOR MARKETING PURPOSES ONLY, ALL DIMENSIONS ARE APPROXIMATE AND NOT TO SCALE. THEY ARE SUBJECT TO ERRORS AND INACCURACIES AND NO LIABILITY WILL BE ACCEPTED. INTERESTED PARTIES SHOULD MAKE THEIR OWN ENQUIRIES.



IMAGES AND FLOORPLAN BY:  
**IN-HOUSE**  
IMAGING  
[inhouseimaging.com.au](http://inhouseimaging.com.au)