



54 Tilshead Road ELIZABETH NORTH SA

2  1  4 

For an in-depth look at this home, please click on the 3D tour for a virtual walk-through

Virtual Tour Link:
<https://my.matterport.com/show/?m=ZG1BQpfgnBF>

To submit an offer, please copy and paste this link into your browser: <https://airtable.com/shrBb12PXtTjyZAXm>

Jake Halliday and Edge Realty are proud to present to the market this amazing, updated and low maintenance abode ready for its next owner. Looking for an entry into the market or another investment to add to the portfolio, this property ticks all of the boxes.

Updated, centrally located and set on a large lot, this is a property that will tick all the boxes whether you're a first-time buyer, a young family or a downsizer. Enjoy fresh

Price : \$ 202,000

View : <https://www.edgerealty.com.au/sale/sa/north-north-east-suburbs/elizabeth-north/residential/house/6491634>



Mike Lao
0410390250

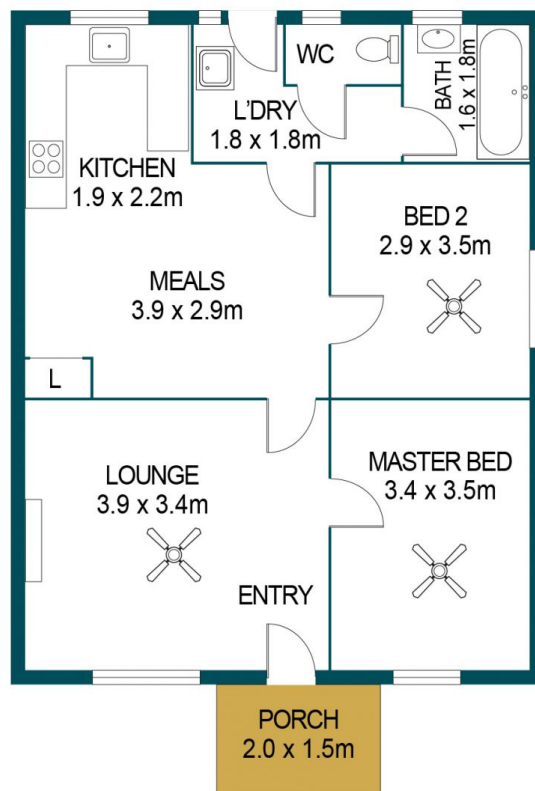
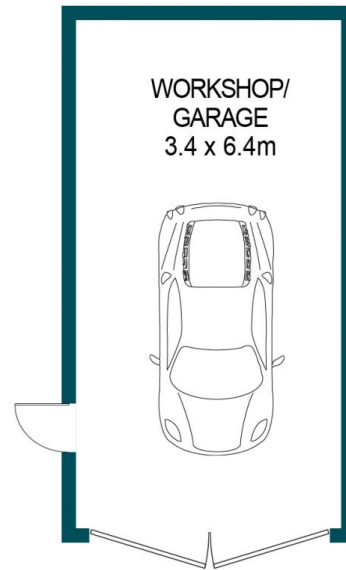

APPROXIMATE DIMENSIONS

LIVING:	74.0m ²
GARAGE:	21.8m ²
PORCH:	3.0m ²
TOTAL:	98.8m ²

54 TILSHEAD ROAD, ELIZABETH NORTH

DISCLAIMER

PLANS SHOWN ARE FOR MARKETING PURPOSES ONLY, ALL DIMENSIONS ARE APPROXIMATE AND NOT TO SCALE. THEY ARE SUBJECT TO ERRORS AND INACCURACIES AND NO LIABILITY WILL BE ACCEPTED. INTERESTED PARTIES SHOULD MAKE THEIR OWN ENQUIRIES.



IMAGES AND FLOORPLAN BY:
IN-HOUSE
IMAGING
inhouseimaging.com.au