



## 7 Jonas Street MUNNO PARA SA

2  1  1 

DUE TO CURRENT COVID-19 RESTRICTIONS IN SOUTH AUSTRALIA, WE ARE NOT ABLE TO CONDUCT OPEN HOMES. PLEASE APPLY AS NORMAL AND ONCE RESTRICTIONS EASE, WE WILL MAKE CONTACT TO ARRANGE PRIVATE INSPECTIONS.

At Edge Realty we are committed to the health and well being of our team, their families and our wider community. Working within the guidelines of the World Health Organisation and the Australian Department of Health, we have implemented new precautions with regard to how we conduct our inspections.

**Step 1**  
Please view the online digital 360 tour (if available), photos and floorplan prior to submitting an application.

**View :** <https://www.edgerealty.com.au/lease/sa/north-north-east-suburbs/munno-para/residential/house/6545800>



**Emma Robinson**  
0497999951



**Kymba Zanker**  
0487888821

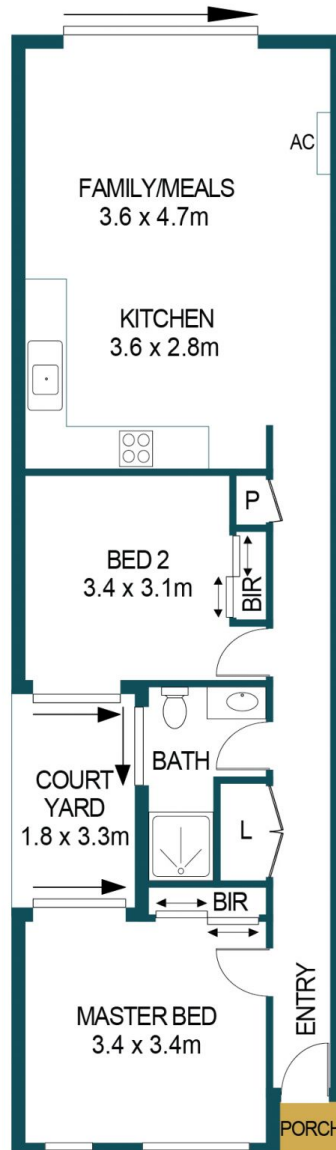
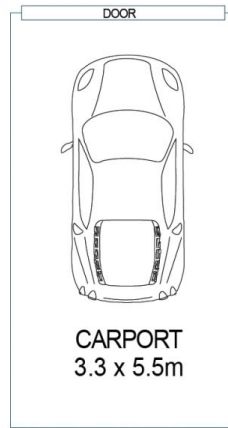

PROPOSED RESIDENCE	
LIVING:	69.7m <sup>2</sup>
CARPORT:	18.2m <sup>2</sup>
COURTYARD:	5.9m <sup>2</sup>
PORCH:	0.7m <sup>2</sup>
TOTAL:	94.5m <sup>2</sup>

## 7 JONAS STREET, MUNNO PARA

### DISCLAIMER

PLANS SHOWN ARE FOR MARKETING PURPOSES ONLY, ALL DIMENSIONS ARE APPROXIMATE AND NOT TO SCALE. THEY ARE SUBJECT TO ERRORS AND INACCURACIES AND NO LIABILITY WILL BE ACCEPTED. INTERESTED PARTIES SHOULD MAKE THEIR OWN ENQUIRIES.

