

## 14 Lorna Street SALISBURY SA

3  1  4 

\*For an in-depth look at this home, please click on the 3D tour for a virtual walk-through\*

Virtual Tour Link:  
<https://my.matterport.com/show/?m=e9LhmeKto76>

To submit an offer, please follow this link:  
<https://airtable.com/shrBb12PXtTjyZAXm>

Matt Ashford and Edge Realty are proud to present to the market 14 Lorna Street, Salisbury.

Located just a short walk from the local park and bus stop is this charming brick home bursting with potential. The bright and inviting layout offers three bedrooms, plus a central bathroom ready for you to revitalise with a few modern touches.

**Price** : \$ 375,000  
**Building Size** : 124 sqm  
**Land Size** : 720 sqm  
**View** : <https://www.edgerealty.com.au/sale/sa/north-north-east-suburbs/salisbury/residential/house/6558454>



**Matt Ashford**  
 0487888178

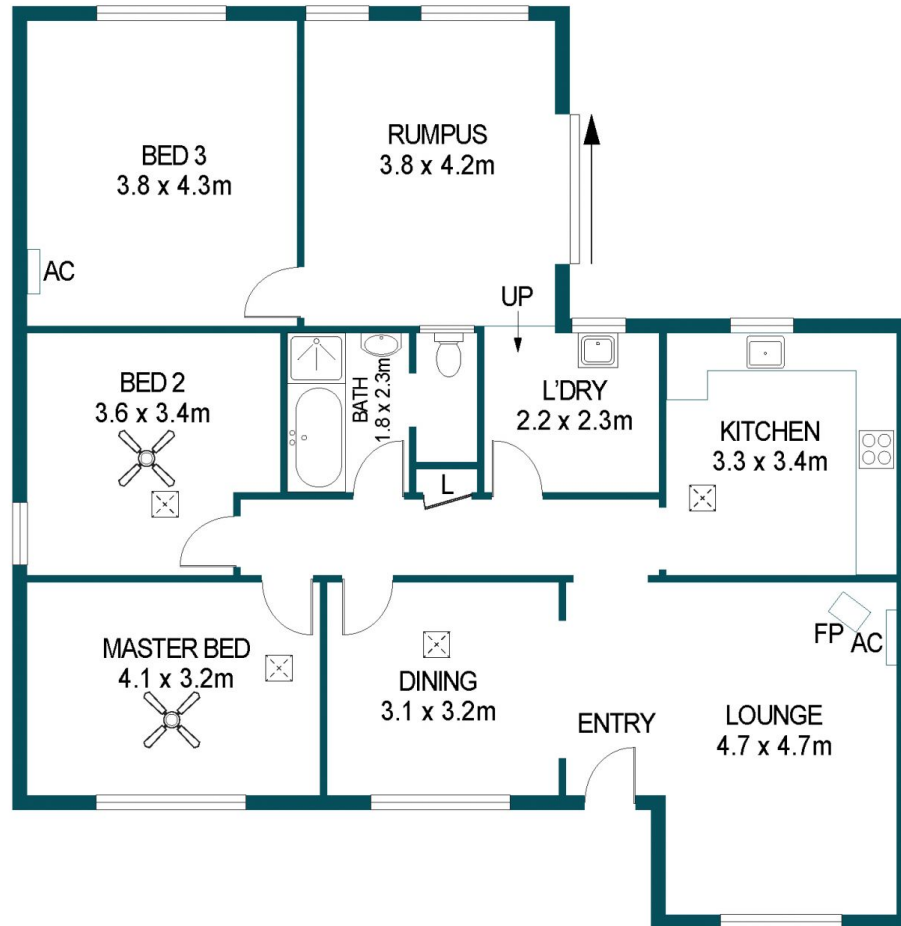
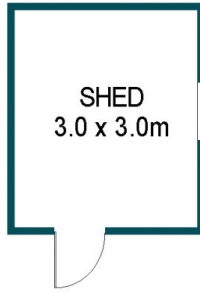
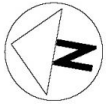

APPROXIMATE DIMENSIONS	
LIVING:	124.9m <sup>2</sup>
SHED:	9.0m <sup>2</sup>
STORAGE:	3.4m <sup>2</sup>
TOTAL:	137.3m <sup>2</sup>

## 14 LORNA STREET, SALISBURY

### DISCLAIMER

PLANS SHOWN ARE FOR MARKETING PURPOSES ONLY, ALL DIMENSIONS ARE APPROXIMATE AND NOT TO SCALE. THEY ARE SUBJECT TO ERRORS AND INACCURACIES AND NO LIABILITY WILL BE ACCEPTED. INTERESTED PARTIES SHOULD MAKE THEIR OWN ENQUIRIES.



IMAGES AND FLOORPLAN BY:  
**IN-HOUSE**  
IMAGING  
[inhouseimaging.com.au](http://inhouseimaging.com.au)