



2 Mildren Court GREENWITH SA

6 2 2

For an in-depth look at this home, please click on the 3D tour for a virtual walk-through

Virtual Tour Link:
<https://my.matterport.com/show/?m=LnRmwphuQv2>

To submit an offer, please copy and paste this link into your browser: <https://airtable.com/shrBb12PXtTjyZAXm>

Mike Lao, Tom Dunstan and Edge Realty are proud to present to the market this stately home that will delight anyone who loves the finer things in life. This beautiful heritage-inspired residence is enveloped by lush gardens with a circular driveway and paver steps leading to the leadlight front door.

Step inside to discover this beautifully built Rossdale home with 9ft ceilings and an expansive layout with five

Price : \$ 770,000
Building Size : 194 sqm
Land Size : 763 sqm
View : <https://www.edgerealty.com.au/sale/sa/north-north-east-suburbs/greenwith/residential/house/6747432>



Mike Lao
0410390250



Tom Dunstan
0429656820

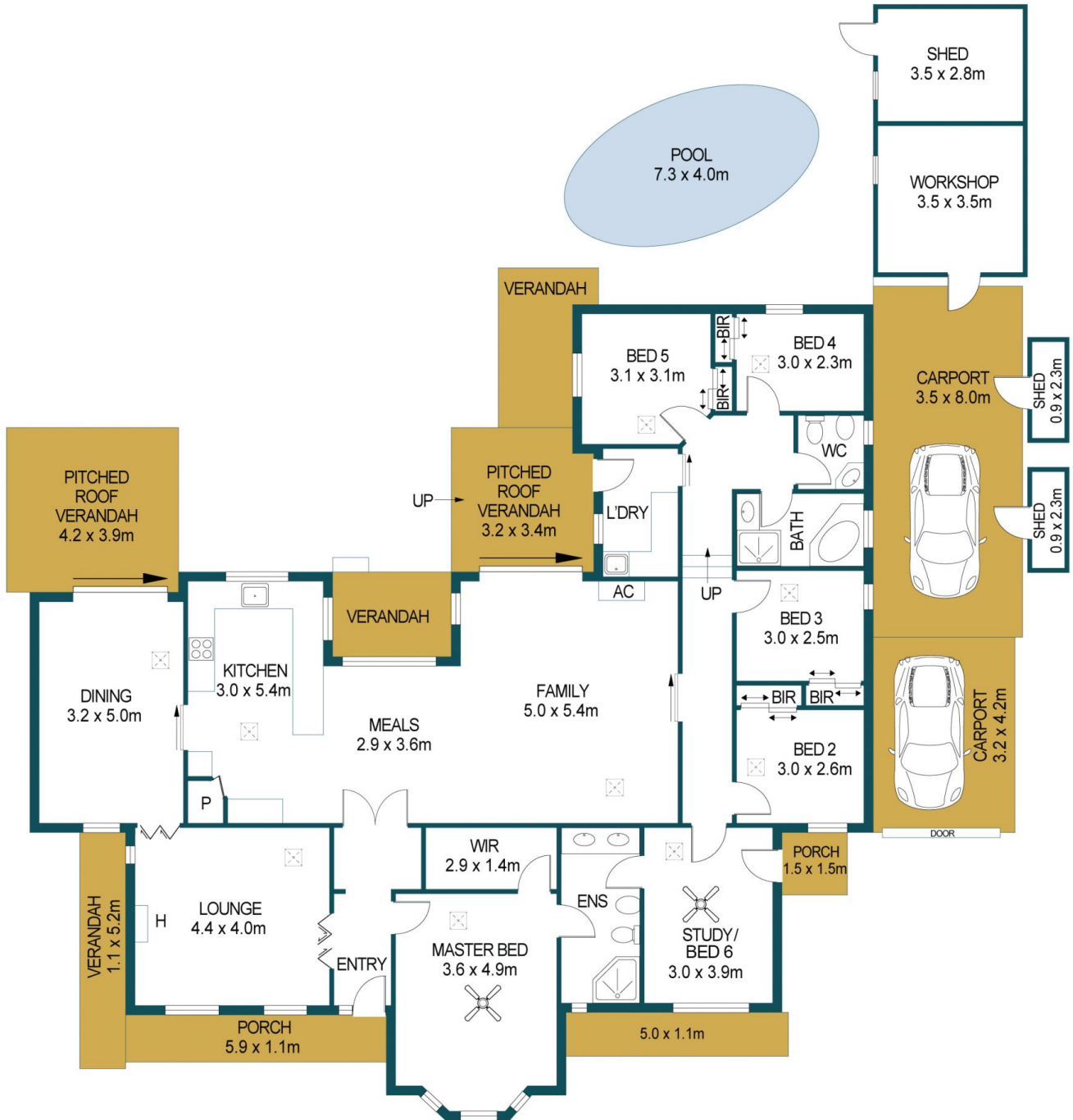

APPROXIMATE DIMENSIONS

LIVING:	194.6m ²
CARPORT:	41.4m ²
SHED/PORCH:	22.4m ²
WORKSHOP:	12.3m ²
VERANDAH:	34.7m ²
TOTAL:	305.4m²

2 MILDREN COURT, GREENWITH

DISCLAIMER

PLANS SHOWN ARE FOR MARKETING PURPOSES ONLY, ALL DIMENSIONS ARE APPROXIMATE AND NOT TO SCALE. THEY ARE SUBJECT TO ERRORS AND INACCURACIES AND NO LIABILITY WILL BE ACCEPTED. INTERESTED PARTIES SHOULD MAKE THEIR OWN ENQUIRIES.



IMAGES AND FLOORPLAN BY:
IN-HOUSE
 IMAGING
inhouseimaging.com.au