



9 Bristol Crescent DAVOREN PARK SA

3  2  1 

For an in-depth look at this home, please click on the 3D tour for a virtual walk-through

Virtual Tour Link:
<https://my.matterport.com/show/?m=giDDEp5NafB>

To submit an offer, please copy and paste this link into your browser: <https://airtable.com/shrBb12PXtTjyZAXm>

Mike Lao, Tyson Bennett and Edge Realty RLA256385 are proud to present to the market this beautifully presented family home located close to everything you could ever need. With shops, schools, parks and public transport links all at your fingertips, it's hard to imagine a more convenient lifestyle than that on offer at 9 Bristol Crescent.

Set behind the fenced and gated front yard is this modern abode promising the life of leisure you've been craving.

Price : \$ 430,000
Building Size : 142 sqm
Land Size : 544 sqm
View : <https://www.edgerealty.com.au/sale/sa/north-north-east-suburbs/davoren-park/residential/house/6902826>



Mike Lao
0410390250



Tyson Bennett
0437161997

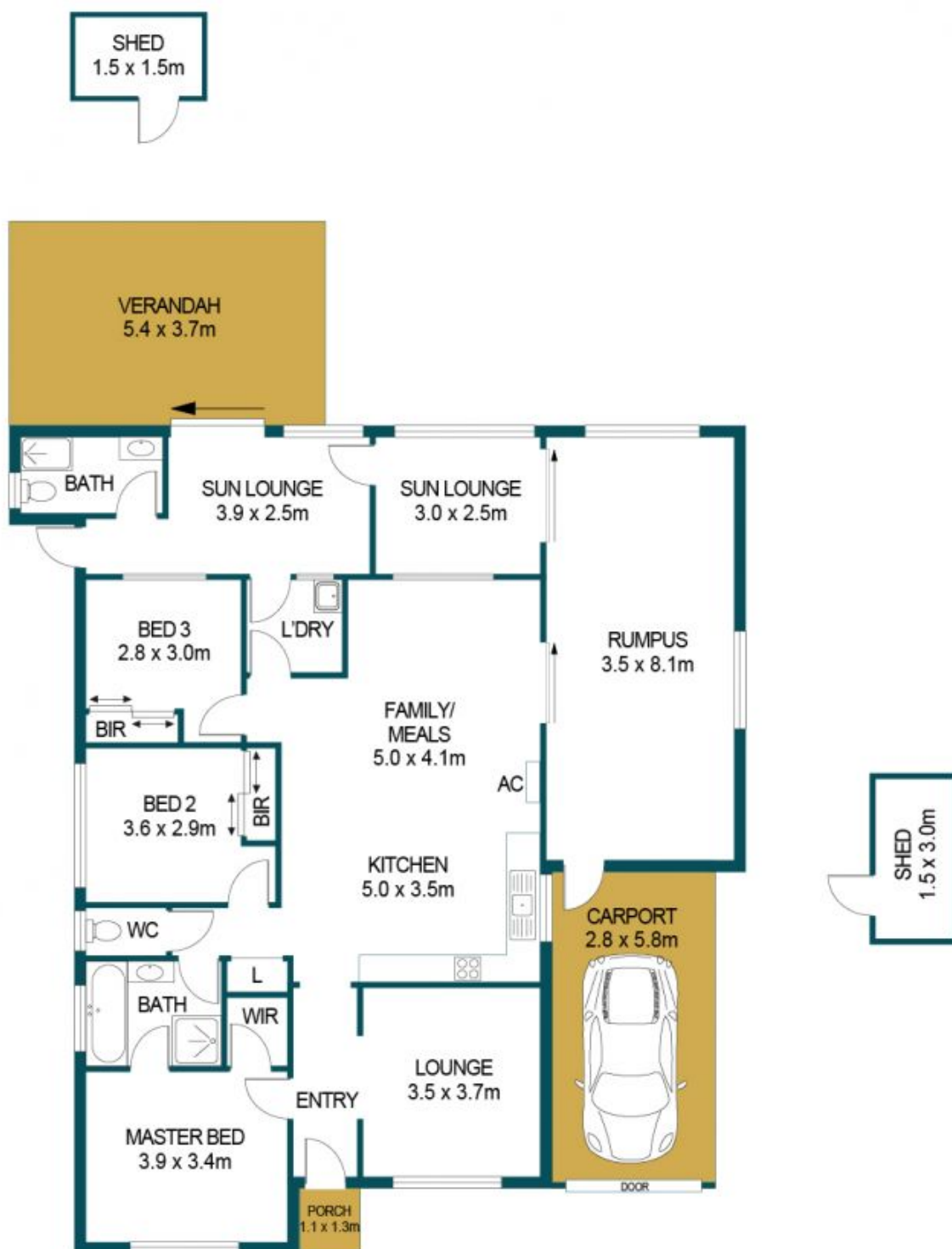

9 BRISTOL CRESCENT, DAVOREN PARK

APPROXIMATE DIMENSIONS	
LIVING:	142.9m ²
PORCH:	1.4m ²
CARPORT:	16.2m ²
SHED:	6.8m ²
VERANDAH:	19.9m ²
TOTAL:	187.2m ²

DISCLAIMER

PLANS SHOWN ARE FOR MARKETING PURPOSES ONLY. ALL DIMENSIONS ARE APPROXIMATE AND NOT TO SCALE. THEY ARE SUBJECT TO ERRORS AND INACCURACIES AND NO LIABILITY WILL BE ACCEPTED. INTERESTED PARTIES SHOULD MAKE THEIR OWN ENQUIRIES.



IMAGES AND FLOORPLAN BY:
IN-HOUSE
IMAGING
inhouseimaging.com.au