



3/44 Charlotte Street SMITHFIELD SA

3 1 1

For an in-depth look at this home, please click on the 3D tour for a virtual walk-through

Virtual Tour Link:
<https://my.matterport.com/show/?m=NRkK4yWsEA>

To submit an offer, please copy and paste this link into your browser: <https://airtable.com/shrBb12PXtTjyZAXm>

Mike Lao, Brendon Ly and Edge Realty RLA256385 are proud to present to the market this well-maintained home nestled within a friendly pocket of Smithfield.

Welcoming and stylish, this home has been designed for family living. All three bedrooms are generous in size, with the master bedroom dual built in robes and ensuite access to the main bathroom. Bedrooms two and three both have built in robes and are ideally situated close to the main

Price : \$ 315,315
Building Size : 88 sqm
Land Size : 284 sqm
View : <https://www.edgerealty.com.au/sale/sa/north-north-east-suburbs/smithfield/residential/unit/6935109>



Mike Lao
0410390250



Brendon Ly
0447888444

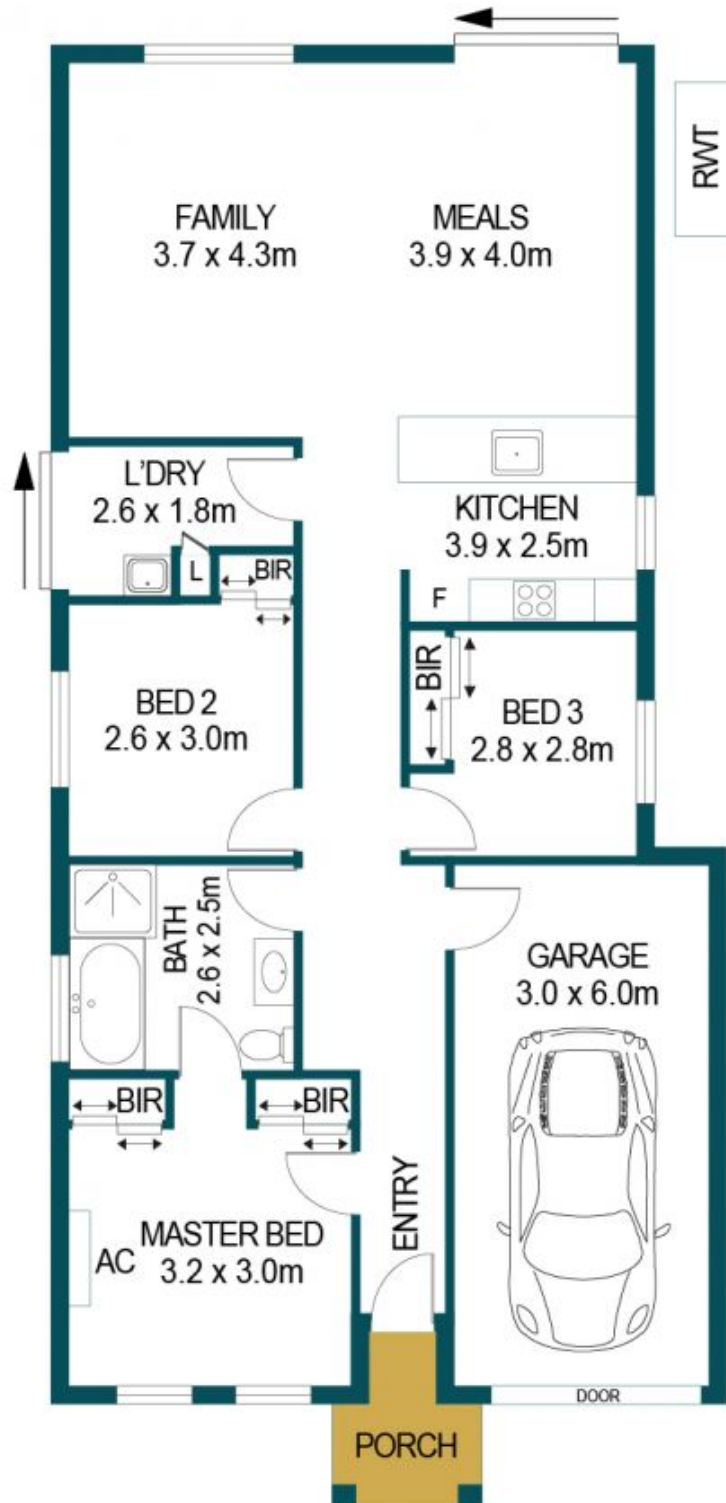

APPROXIMATE DIMENSIONS	
LIVING:	88.1m ²
GARAGE:	18.0m ²
PORCH:	3.0m ²
TOTAL:	109.1m ²

3/44 CHARLOTTE STREET, SMITHFIELD

DISCLAIMER

PLANS SHOWN ARE FOR MARKETING PURPOSES ONLY. ALL DIMENSIONS ARE APPROXIMATE AND NOT TO SCALE. THEY ARE SUBJECT TO ERRORS AND INACCURACIES AND NO LIABILITY WILL BE ACCEPTED. INTERESTED PARTIES SHOULD MAKE THEIR OWN ENQUIRIES.



IMAGES AND FLOORPLAN BY:
IN-HOUSE
IMAGING
inhouseimaging.com.au