



## 22 Queen Street SMITHFIELD SA

2 1 2

\*For an in-depth look at this home, please click on the 3D tour for a virtual walk-through\*

Virtual Tour Link: <https://my.matterport.com/show/?m=zew45P6CZpy>

To submit an offer, please copy and paste this link into your browser: <https://airtable.com/shrBb12PXtTjyZAXm>

Mike Lao, Tyson Bennett and Edge Realty RLA256385 are proud to present to the market this centrally located, low-maintenance home that is bursting with potential. Situated on a large 1,019sqm block zoned as a township activity centre, this property offers both convenience and future potential. The property is currently tenanted with a periodic lease of \$190 per week in place.

Whether you're looking a large block in a great location to

**Price** : \$ 325,551  
**Building Size** : 67 sqm  
**Land Size** : 1020 sqm  
**View** : <https://www.edgerealty.com.au/sale/sa/north-north-east-suburbs/smithfield/residential/house/6945815>



**Mike Lao**  
0410390250



**Tyson Bennett**  
0437161997

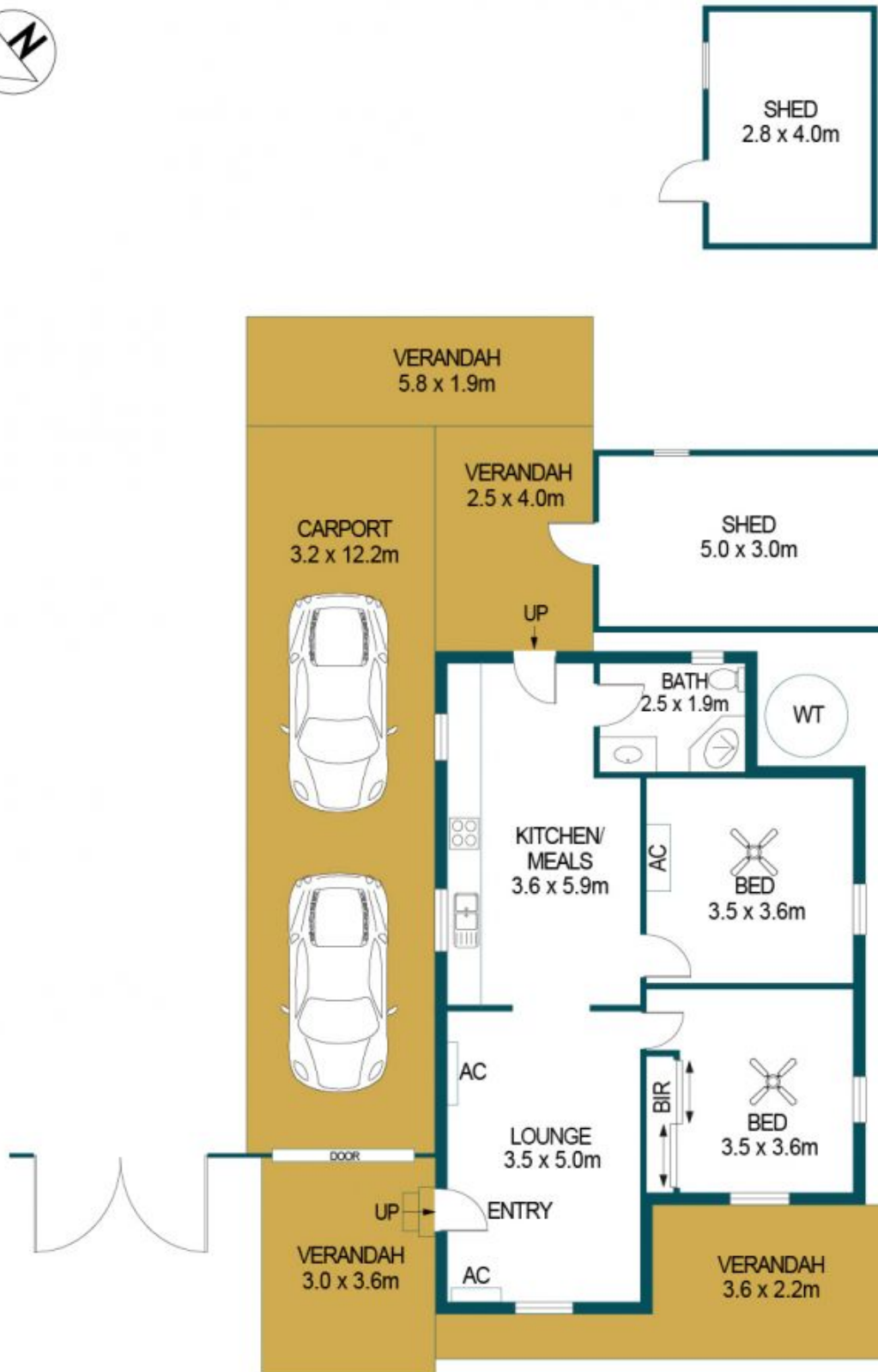

APPROXIMATE DIMENSIONS	
LIVING:	67.1m <sup>2</sup>
VERANDAH:	38.8m <sup>2</sup>
CARPORT:	39.0m <sup>2</sup>
SHED:	15.0m <sup>2</sup>
TOTAL:	159.9m <sup>2</sup>

## 22 QUEEN STREET, SMITHFIELD

### DISCLAIMER

PLANS SHOWN ARE FOR MARKETING PURPOSES ONLY. ALL DIMENSIONS ARE APPROXIMATE AND NOT TO SCALE. THEY ARE SUBJECT TO ERRORS AND INACCURACIES AND NO LIABILITY WILL BE ACCEPTED. INTERESTED PARTIES SHOULD MAKE THEIR OWN ENQUIRIES.



IMAGES AND FLOORPLAN BY:  
**IN-HOUSE**  
IMAGING  
inhouseimaging.com.au