

## 15 Moore Avenue SALISBURY EAST SA

4  1  3 

\*For an in-depth look at this home, please click on the 3D tour for a virtual walk-through or copy and paste this link into your browser\*

Virtual Tour Link:  
<https://my.matterport.com/show/?m=PrMvDjqzNeU>

To submit an offer, please copy and paste this link into your browser:  
<https://www.edgerealty.com.au/buying/make-an-offer/>

Mike Lao, Brendon Ly and Edge Realty RLA256385 are proud to present to the market this comfortable solid brick family home that is bursting with appeal. The house is move-in-ready, meaning you can simply unpack and relax, or you could look to modernise with your own personal touches, the choice is yours. Its central location also makes it an excellent investment opportunity for those looking to

**Price** : \$ 500,000  
**Building Size** : 127 sqm  
**Land Size** : 580 sqm  
**View** : <https://www.edgerealty.com.au/sale/sa/north-north-east-suburbs/salisbury-east/residential/house/7082366>



**Mike Lao**  
0410390250



**Brendon Ly**  
0447888444

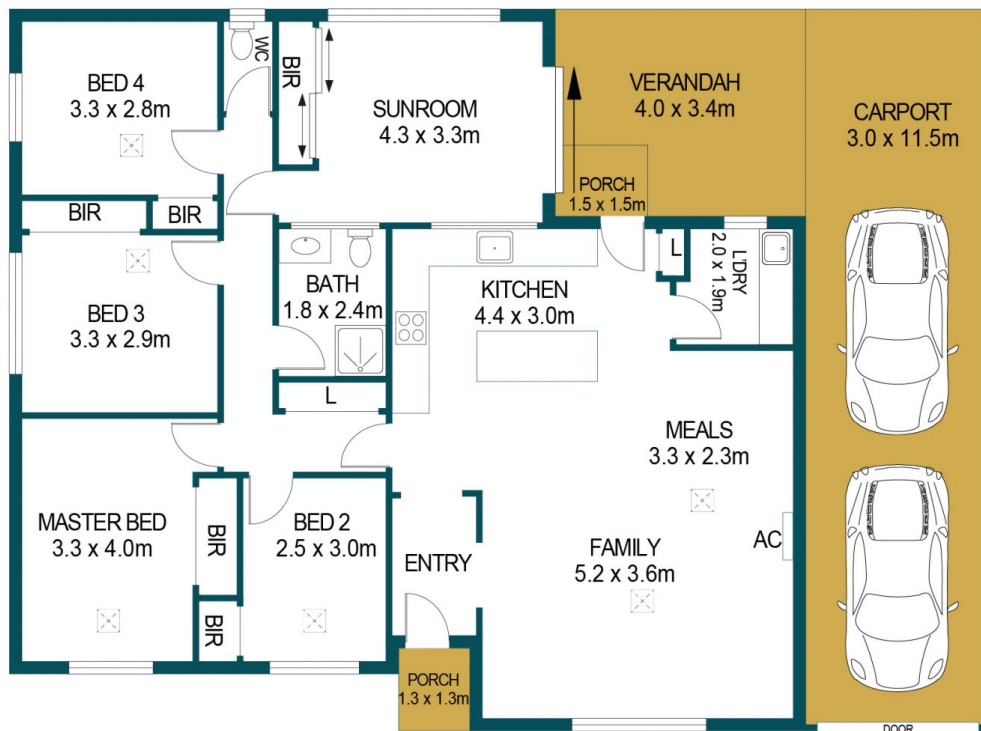

## 15 MOORE AVENUE, SALISBURY EAST

APPROXIMATE DIMENSIONS	
LIVING:	127.0m <sup>2</sup>
VEANDAH:	13.6m <sup>2</sup>
PORCH:	2.3m <sup>2</sup>
CARPORT:	34.5m <sup>2</sup>
WORKSHOP:	21.0m <sup>2</sup>
TOTAL:	198.4m <sup>2</sup>

### Disclaimer

Plans shown are for marketing purposes only. All dimensions are approximate and not to scale. They are subject to errors and inaccuracies and no liability will be accepted. Interested parties should make their own enquiries. Inclusions and exclusions must be confirmed in the Residential Contract.



IMAGES AND FLOORPLAN BY:  
**IN-HOUSE**  
IMAGING  
[inhouseimaging.com.au](http://inhouseimaging.com.au)