



## 14 Tulipwood Court GREENWITH SA

3 1 1

\*For an in-depth look at this home, please click on the 3D tour for a virtual walk-through or copy and paste this link into your browser\*

Virtual Tour Link:  
<https://vtc.virtualtourscreator.com.au/share/6f958c776c1b183d3bb482f219004bb7>

To submit an offer, please copy and paste this link into your browser: <https://airtable.com/shrBb12PXtTjyZAXm>

Mike Lao, Brendon Ly and Edge Realty RLA256385 are proud to present to the market this delightful three bedroom, one bathroom home in sunny Greenwith. With wonderful open plan living and a great location on the corner block of a quiet street, this is a great home for young families. The property is currently tenanted with a fixed lease of \$325 per week in place until 21/10/2022.

**Price** : \$ 459,000  
**Building Size** : 99 sqm  
**Land Size** : 389 sqm  
**View** : <https://www.edgerealty.com.au/sale/sa/north-north-east-suburbs/greenwith/residential/house/7119884>



**Mike Lao**  
0410390250



**Brendon Ly**  
0447888444

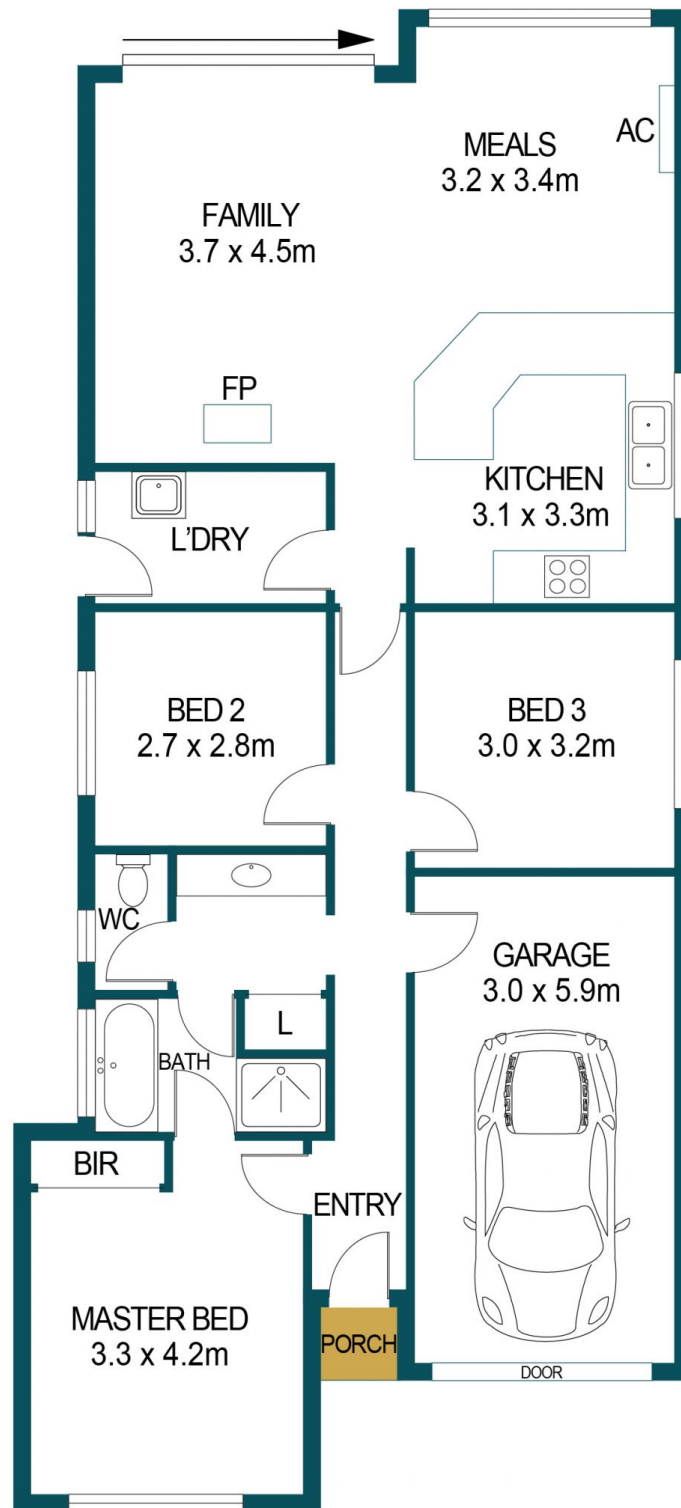

## 14 TULIPWOOD COURT, GREENWITH

### Disclaimer

Plans shown are for marketing purposes only. All dimensions are approximate and not to scale. They are subject to errors and inaccuracies and no liability will be accepted. Interested parties should make their own enquiries. Inclusions and exclusions must be confirmed in the Residential Contract.

### APPROXIMATE DIMENSIONS

LIVING:	99.8m <sup>2</sup>
PORCH:	0.9m <sup>2</sup>
GARAGE:	17.8m <sup>2</sup>
TOTAL:	118.5m <sup>2</sup>