



38 Blight Street DAVOREN PARK SA

3 1 1

For an in-depth look at this home, please click on the 3D tour for a virtual walk-through or copy and paste this link into your browser

Virtual Tour Link:
<https://vtc.virtualtourscreator.com.au/share/878bb3494a5446206d116cb65d8485e8>

To submit an offer, please copy and paste this link into your browser:

<https://www.edgerealty.com.au/buying/make-an-offer/>

Mike Lao, Tyson Bennett and Edge Realty RLA256385 are proud to present to the market this easy-care home that's sure to appeal to a wide range of buyers. The single-storey floorplan is as functional as it is comfortable while the generous 539sqm lot provides a large backyard that the kids will love. The property has a great long term tenant

Price : \$ 232,000
Building Size : 168 sqm
Land Size : 539 sqm
View : <https://www.edgerealty.com.au/sale/sa/north-north-east-suburbs/davoren-park/residential/house/7159125>



Mike Lao
0410390250



Tyson Bennett
0437161997

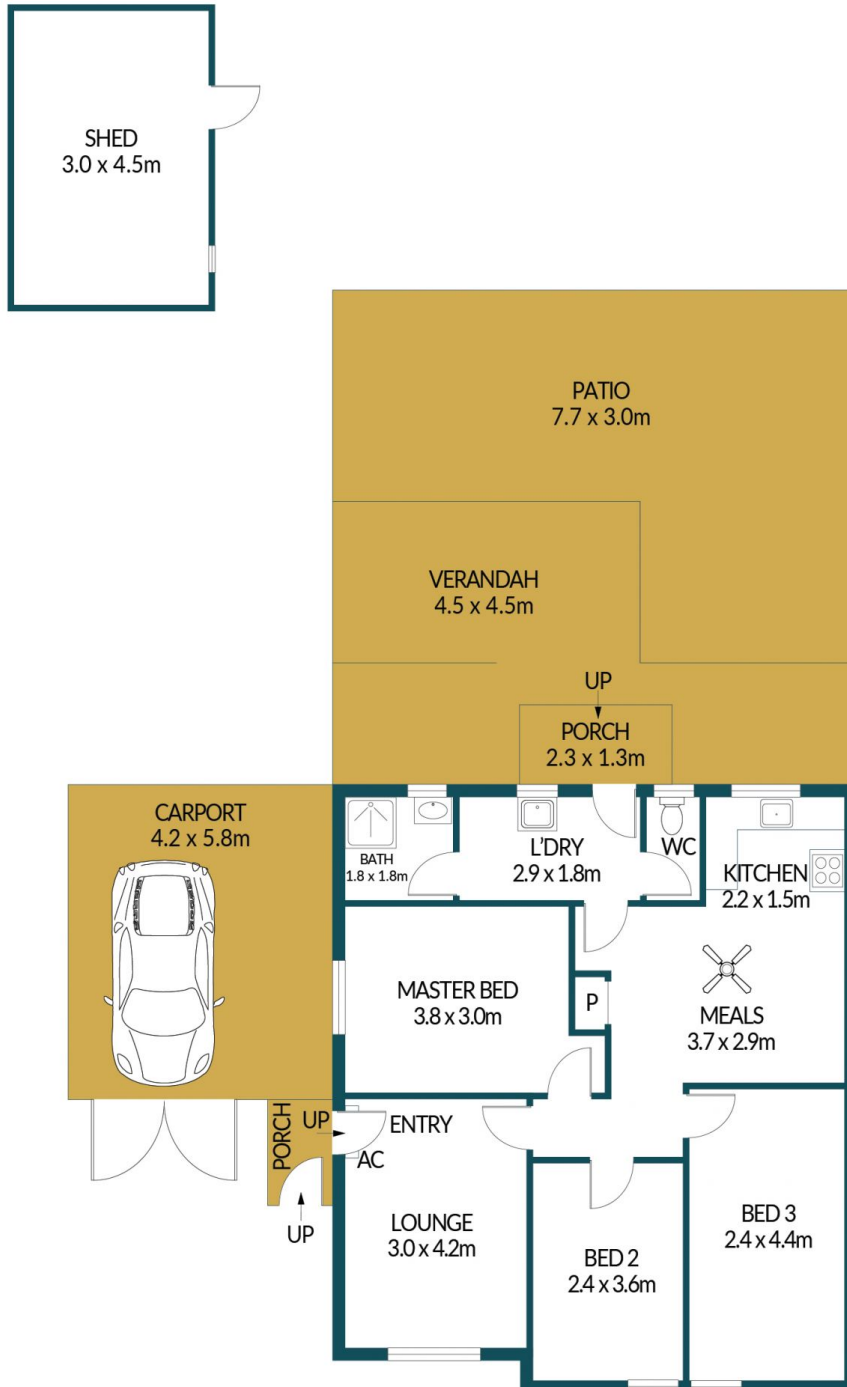

38 BLIGHT STREET, DAVOREN PARK

Disclaimer

Plans shown are for marketing purposes only. All dimensions are approximate and not to scale. They are subject to errors and inaccuracies and no liability will be accepted. Interested parties should make their own enquiries. Inclusions and exclusions must be confirmed in the Residential Contract.

APPROXIMATE DIMENSIONS

LIVING:	80.1m ²
CARPORT:	28.8m ²
VERANDAH/PORCH:	23.2m ²
PATIO/SHED:	36.1m ²
TOTAL:	168.2m ²