

7 Forrestall Road ELIZABETH DOWNS SA

3 1 3

For an in-depth look at this home, please click on the 3D tour for a virtual walk-through or copy and paste this link into your browser

Virtual <https://my.matterport.com/show/?m=Br1kK6bTyj3> Tour Link:

To submit an offer, please copy and paste this link into your browser:
<https://www.edgerealty.com.au/buying/make-an-offer/>

Mike Lao, Brendon Ly and Edge Realty RLA256385 are proud to present to the market this low-maintenance family home on an 800sqm corner block in Elizabeth Downs. With updated finishes and fixtures throughout, yet still plenty of room to add your personal touches and style, this property is sure to capture the attention of a wide range of eager house hunters.

Price : \$ 350,000
Building Size : 90 sqm
Land Size : 800 sqm
View : <https://www.edgerealty.com.au/sale/sa/north-north-east-suburbs/elizabeth-downs/residential/house/7183119>



Mike Lao
0410390250



Brendon Ly
0447888444

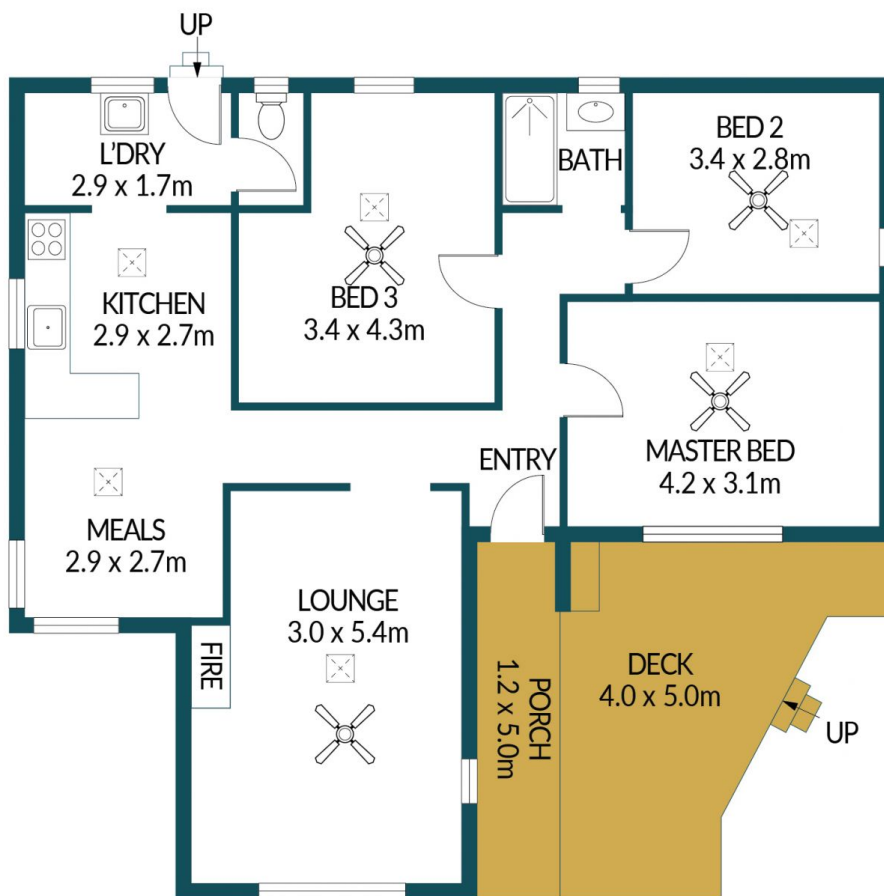
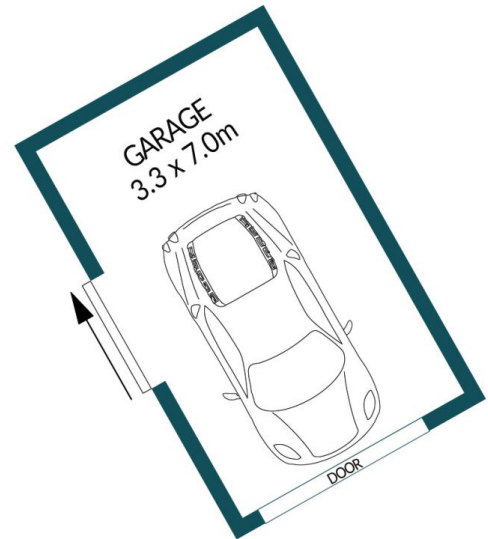

7 FORRESTALL ROAD, ELIZABETH DOWNS

Disclaimer

Plans shown are for marketing purposes only. All dimensions are approximate and not to scale. They are subject to errors and inaccuracies and no liability will be accepted. Interested parties should make their own enquiries. Inclusions and exclusions must be confirmed in the Residential Contract.

APPROXIMATE DIMENSIONS

LIVING:	90.6m ²
GARAGE:	23.1m ²
DECK:	20.0m ²
PORCH:	6.0m ²
TOTAL:	139.7m ²