



## 255 Hogarth Road ELIZABETH GROVE SA

3 1 4

\*For an in-depth look at this home, please click on the 3D tour for a virtual walk-through or copy and paste this link into your browser\*

Virtual [Tour](https://my.matterport.com/show/?m=y4PZNKqQzoP) Link:

To submit an offer, please copy and paste this link into your browser:  
<https://www.edgerealty.com.au/buying/make-an-offer/>

Mike Lao, Tyson Bennett and Edge Realty RLA256385 are proud to present to the market this three-bedroom, one-bathroom brick home in the heart of Elizabeth Grove with loads of appeal for investors, developers and homeowners alike. This generous 960sqm parcel of land has a family-sized house, a large backyard and a huge 5.3mx13.1m shed!

**Price** : \$ 375,000  
**Building Size** : 95 sqm  
**Land Size** : 960 sqm  
**View** : <https://www.edgerealty.com.au/sale/sa/north-north-east-suburbs/elizabeth-grove/residential/house/7305128>



**Mike Lao**  
0410390250



**Tyson Bennett**  
0437161997

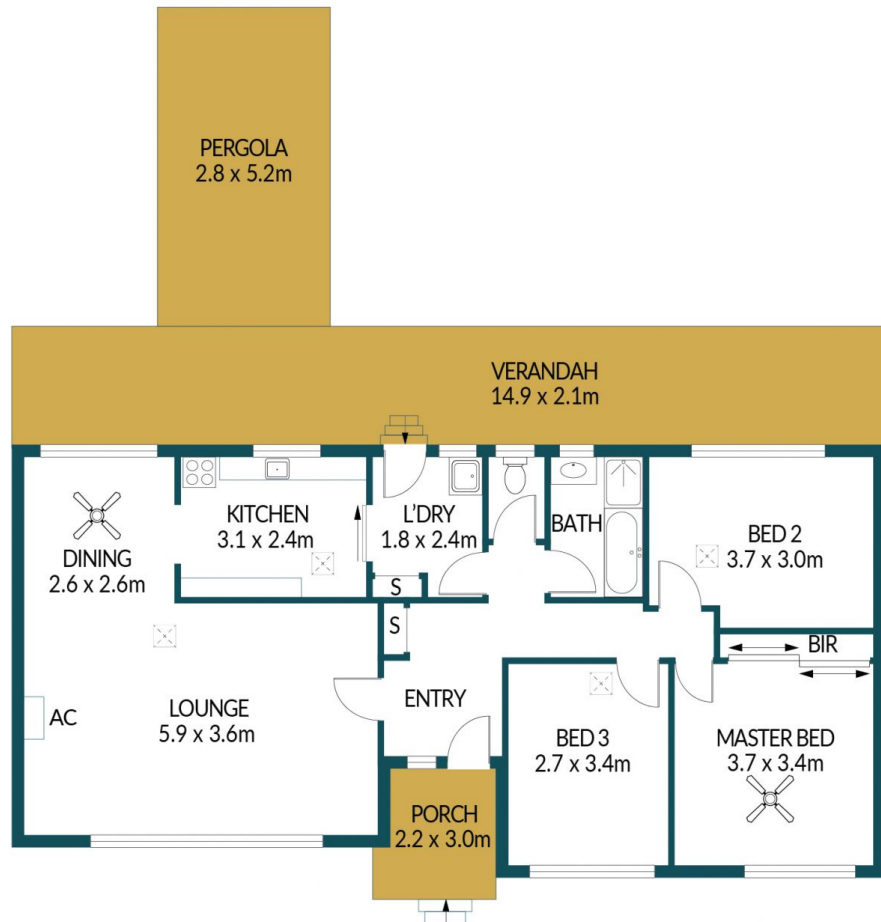
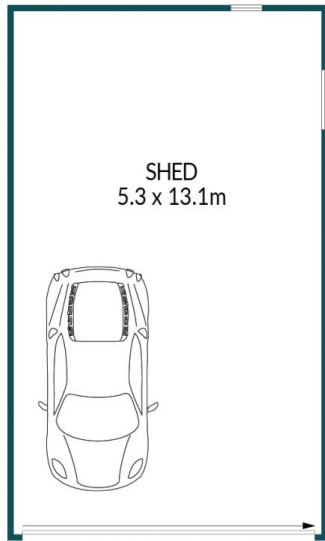

## 255 HOGARTH ROAD, ELIZABETH GROVE

### Disclaimer

Plans shown are for marketing purposes only. All dimensions are approximate and not to scale. They are subject to errors and inaccuracies and no liability will be accepted. Interested parties should make their own enquiries. Inclusions and exclusions must be confirmed in the Residential Contract.

### APPROXIMATE DIMENSIONS

LIVING:	95.8m <sup>2</sup>
SHED:	69.4m <sup>2</sup>
PORCH:	6.5m <sup>2</sup>
PERGOLA/VERANDAH:	45.8m <sup>2</sup>
TOTAL:	217.5m <sup>2</sup>