



5 Lochleven Avenue GREENWITH SA

3 1 3

For an in-depth look at this home, please click on the 3D tour for a virtual walk-through or copy and paste this link into your browser

Virtual <https://my.matterport.com/show/?m=yP4zn6JkeWM> Tour Link:

To submit an offer, please copy and paste this link into your browser:
<https://www.edgerealty.com.au/buying/make-an-offer/>

Mike Lao, Tyson Bennett and Edge Realty RLA256385 are proud to present to the market this stylish family haven set within a peaceful pocket of Greenwith. Everyone from young families dreaming of a stylish place to call their own through to downsizers and investors will be vying to secure this impressive abode. The property currently has fantastic tenants on a fixed lease of \$450 per week in place until

Price : \$ 565,000
Land Size : 380 sqm
View : <https://www.edgerealty.com.au/sale/sa/north-north-east-suburbs/greenwith/residential/house/7365173>



Mike Lao
0410390250



Tyson Bennett
0437161997

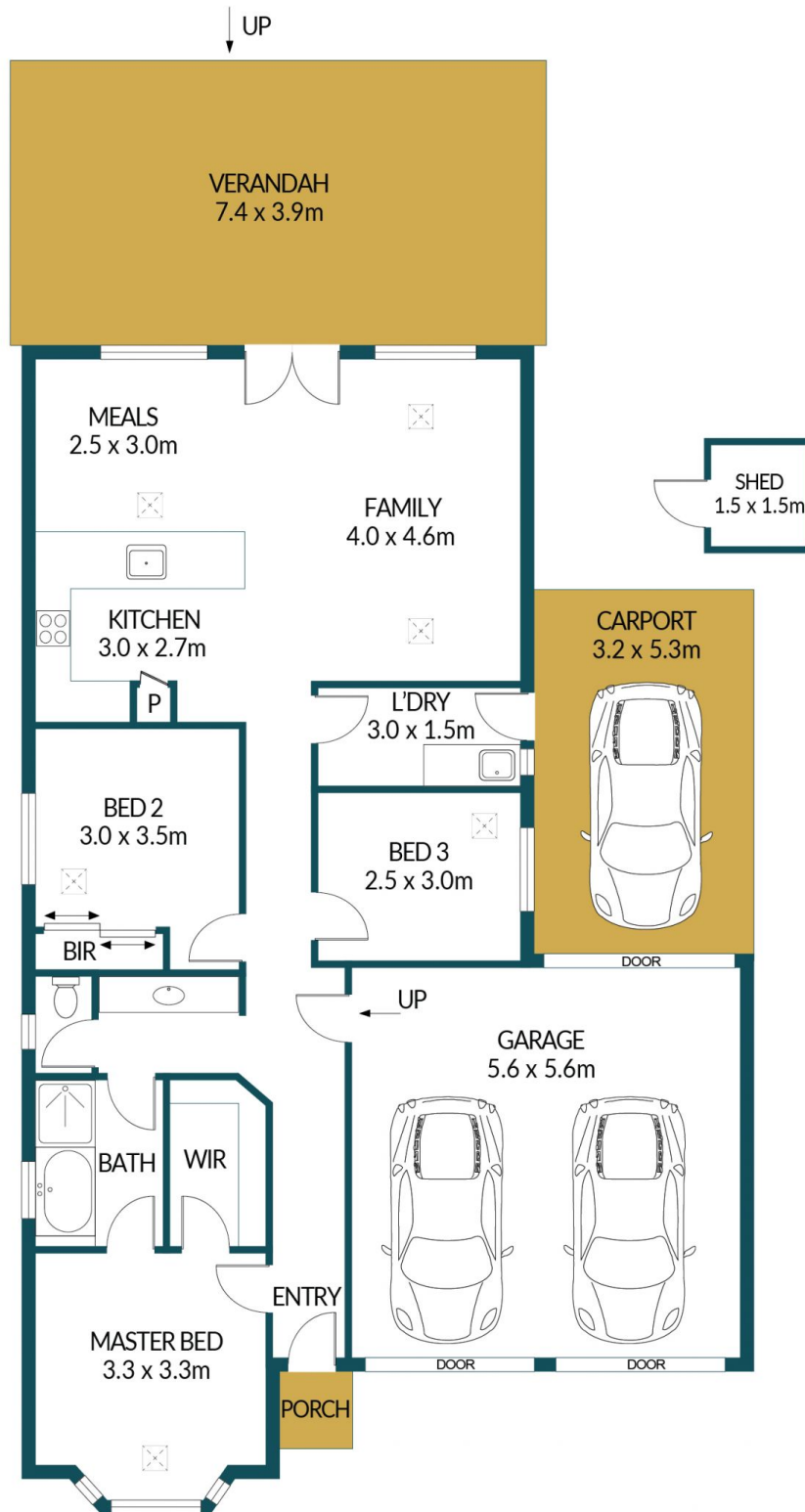

5 LOCHLEVEN AVENUE, GREENWITH

Disclaimer

Plans shown are for marketing purposes only. All dimensions are approximate and not to scale. They are subject to errors and inaccuracies and no liability will be accepted. Interested parties should make their own enquiries. Inclusions and exclusions must be confirmed in the Residential Contract.

APPROXIMATE DIMENSIONS

LIVING:	110.2m ²
GARAGE/CARPORT:	48.3m ²
PORCH/SHED:	3.7m ²
VERANDAH:	28.9m ²
TOTAL:	191.1m ²