



13 Cameron Road ELIZABETH VALE SA

3 1 1

For an in-depth look at this home, please click on the 3D tour for a virtual walk-through or copy and paste this link into your browser

Virtual [Tour](https://my.matterport.com/show/?m=mmUSVeMdPHC) Link:

To submit an offer, please copy and paste this link into your browser:
<https://www.edgerealty.com.au/buying/make-an-offer/>

Mike Lao, Brendon Ly and Edge Realty RLA256385 are proud to present to the market 13 Cameron Road, Elizabeth Vale, an exciting property bursting with potential. Set on a 650sqm block with subdivision potential, this is simply too good to miss whether you have renovation dreams or development aspirations.

Price : \$ 352,000
Building Size : 113 sqm
Land Size : 650 sqm
View : <https://www.edgerealty.com.au/sale/sa/north-north-east-suburbs/elizabeth-vale/residential/house/7372631>



Mike Lao
0410390250



Brendon Ly
0447888444

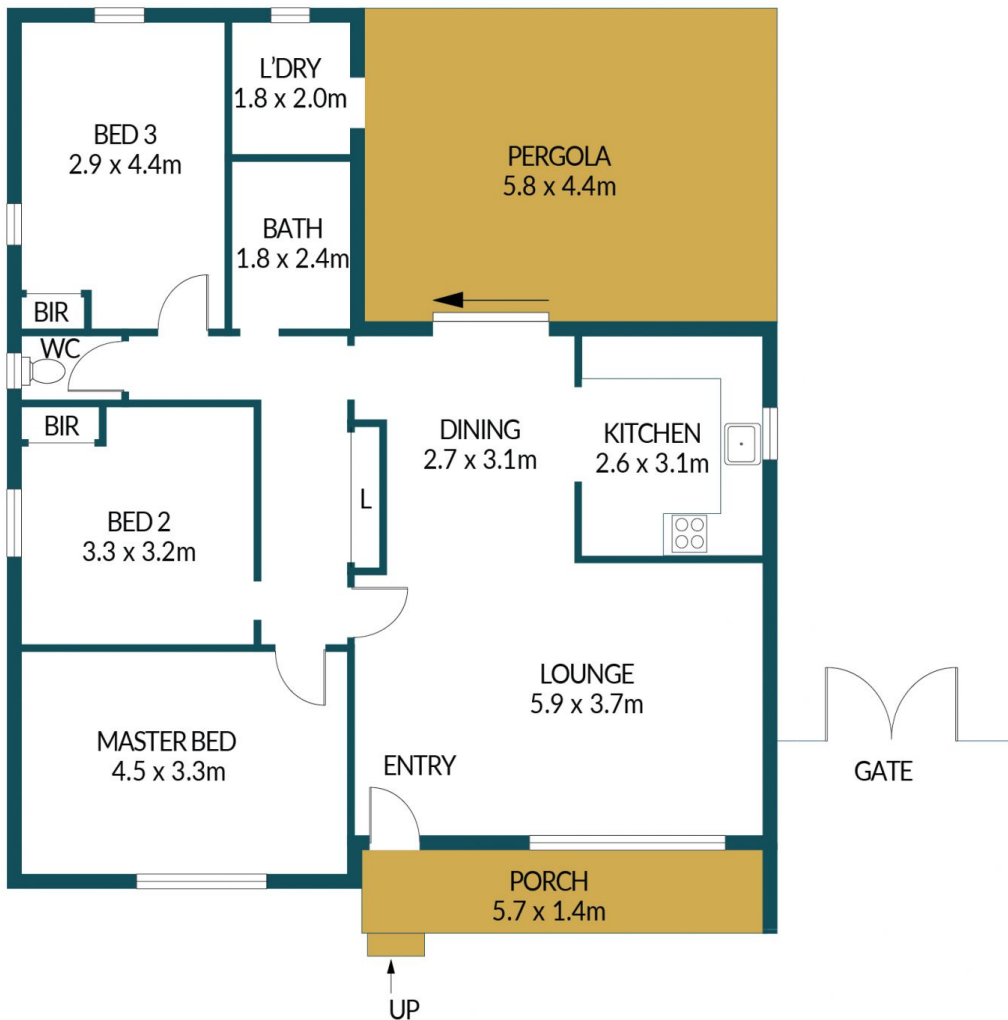
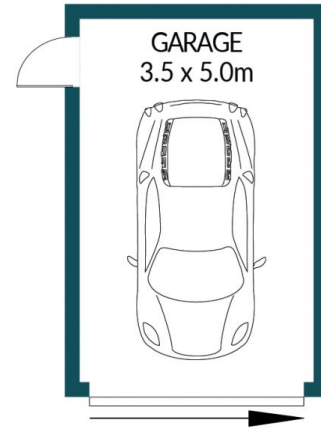

13 CAMERON ROAD, ELIZABETH VALE

Disclaimer

Plans shown are for marketing purposes only. All dimensions are approximate and not to scale. They are subject to errors and inaccuracies and no liability will be accepted. Interested parties should make their own enquiries. Inclusions and exclusions must be confirmed in the Residential Contract.

APPROXIMATE DIMENSIONS

LIVING:	103.7m ²
GARAGE:	17.5m ²
PORCH:	7.9m ²
PERGOLA:	25.5m ²
TOTAL:	154.6m ²