



30 Gerald Boulevard DAVOREN PARK SA

4  2  1 

For an in-depth look at this home, please click on the 3D tour for a virtual walk-through or copy and paste this link into your browser

Virtual Tour Link:
<https://vtc.virtualltourscreator.com.au/share/53b82d59a452f35d57619db4af676678>

To submit an offer, please copy and paste this link into your browser:

<https://www.edgerealty.com.au/buying/make-an-offer/>

Mike Lao, Tyson Bennett and Edge Realty RLA256385 are proud to present to the market this family-friendly home set within a quiet pocket of Davoren Park. From the central open plan layout and large backyard to the fetching location close to shops, parks and schools, there's a lot to love about this impressive abode make it your forever

Price : \$ 448,000
Building Size : 116 sqm
Land Size : 454 sqm
View : <https://www.edgerealty.com.au/sale/sa/north-north-east-suburbs/davoren-park/residential/house/7588421>



Mike Lao
0410390250



Tyson Bennett
0437161997

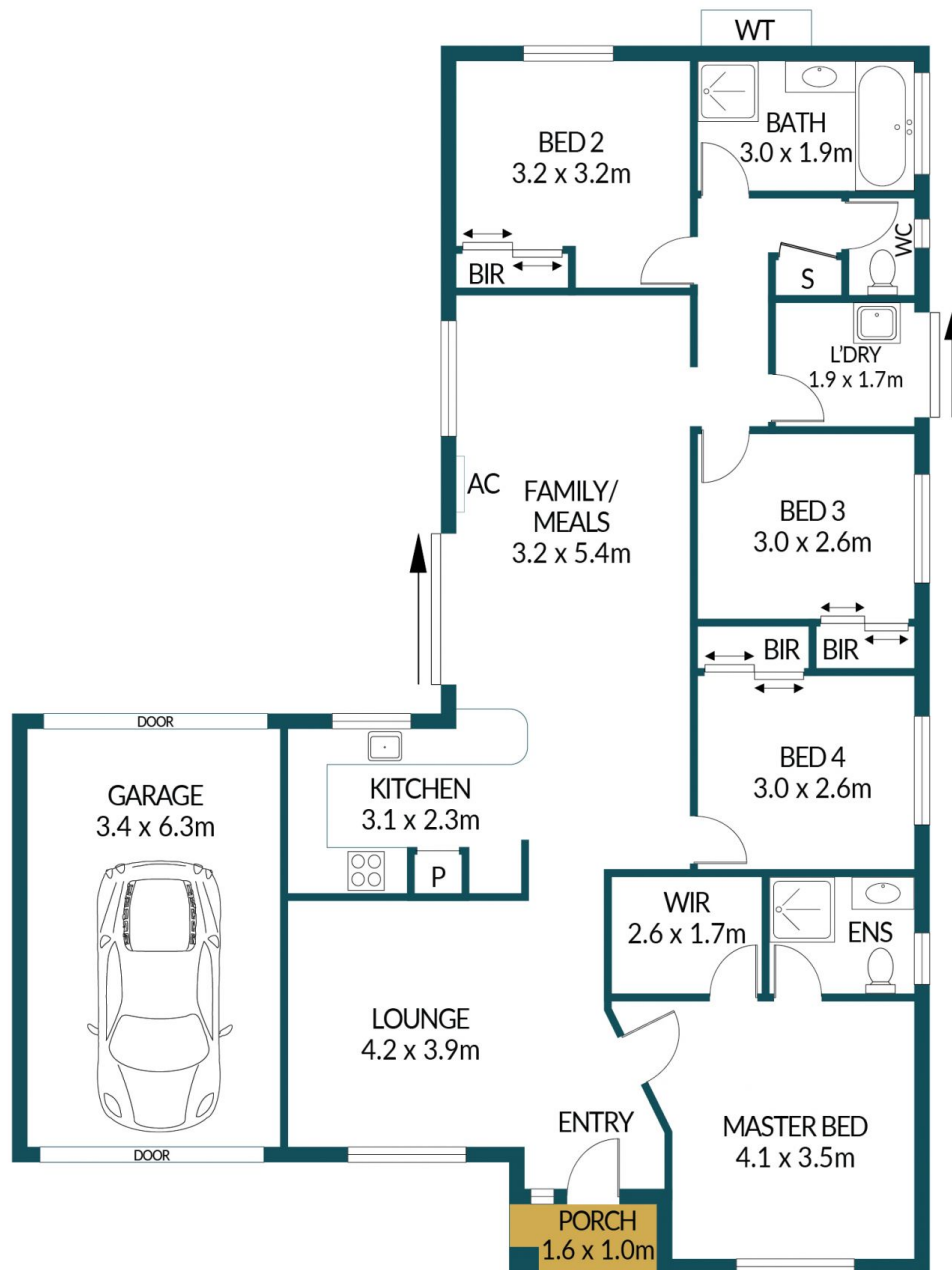

Disclaimer

APPROXIMATE DIMENSIONS

LIVING:	116.6m ²
GARAGE:	21.4m ²
PORCH:	1.6m ²
TOTAL:	139.6m ²