

### 1/18 Mclean Street ELIZABETH PARK SA

3  1  1 

\*For an in-depth look at this home, please click on the 3D tour for a virtual walk-through or copy and paste this link into your browser\*

Virtual Tour Link:  
<https://my.matterport.com/show/?m=HKqGYCJJXGP>

To submit an offer, please copy and paste this link into your browser:  
<https://www.edgerealty.com.au/buying/make-an-offer/>

Mike Lao, Brendon Ly and Edge Realty RLA256385 are proud to present to the market this fantastic opportunity to own a charming unit located at 1/18 Mclean Street, Elizabeth Park. Perfectly suited for first home buyers, investors, and families alike, this property offers a comfortable and low-maintenance lifestyle in a family-friendly neighbourhood.

**Price** : \$ 390,000  
**Building Size** : 81 sqm  
**Land Size** : 235 sqm  
**View** : <https://www.edgerealty.com.au/sale/sa/north-north-east-suburbs/elizabeth-park/residential/unit/7596821>



**Mike Lao**  
0410390250



**Brendon Ly**  
0447888444

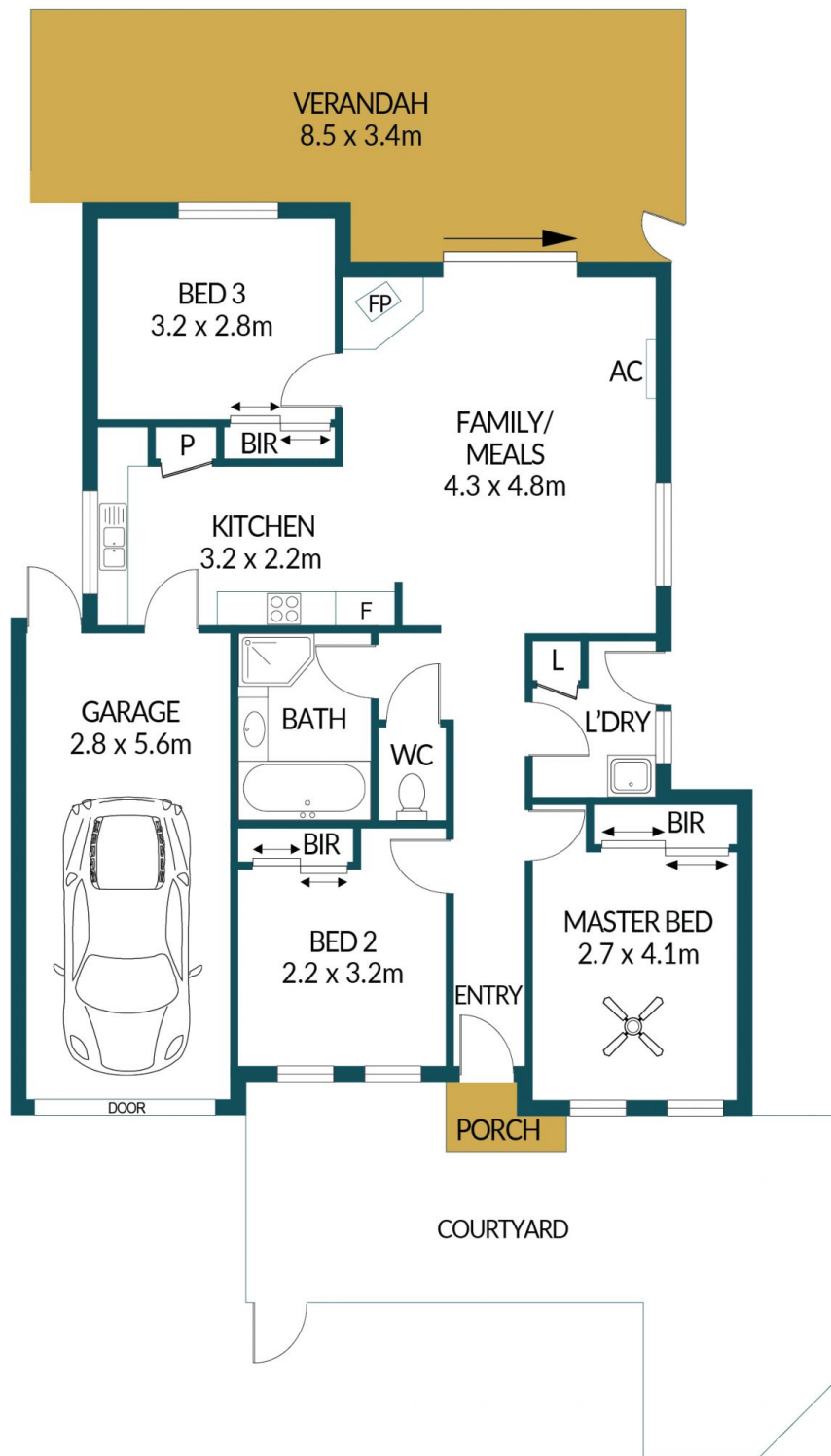

## 1/18 MCLEAN STREET, ELIZABETH PARK

### Disclaimer

Plans shown are for marketing purposes only. All dimensions are approximate and not to scale. They are subject to errors and inaccuracies and no liability will be accepted. Interested parties should make their own enquiries. Inclusions and exclusions must be confirmed in the Residential Contract.

### APPROXIMATE DIMENSIONS

LIVING:	81.2m <sup>2</sup>
GARAGE:	15.7m <sup>2</sup>
PORCH:	1.2m <sup>2</sup>
VERANDAH:	26.1m <sup>2</sup>
TOTAL:	124.2m <sup>2</sup>