



## 2 Greig Court PARALOWIE SA

3 2 5

\*For an in-depth look at this home, please click on the 3D tour for a virtual walk-through\*

Virtual Tour Link: <https://my.matterport.com/show/?m=K8CZghfif5L>

To submit an offer, please copy and paste this link into your browser:  
<https://www.edgerealty.com.au/buying/make-an-offer/>

Mike Lao, Tyson Bennett and Edge Realty RLA256385 are proud to present to the market this exquisite property nestled in a sought-after Paralowie location offering the perfect setting for family living. This character-filled residence, built in 1988 by Fairmont Homes, has been cherished by its original owner and is now ready to welcome a new family. With its inviting features and desirable location, this property is sure to capture your

**Price** : \$ 640,000  
**Building Size** : 153 sqm  
**Land Size** : 750 sqm  
**View** : <https://www.edgerealty.com.au/sale/sa/north-north-east-suburbs/paralowie/residential/house/7620074>



**Mike Lao**  
0410390250



**Tyson Bennett**  
0437161997

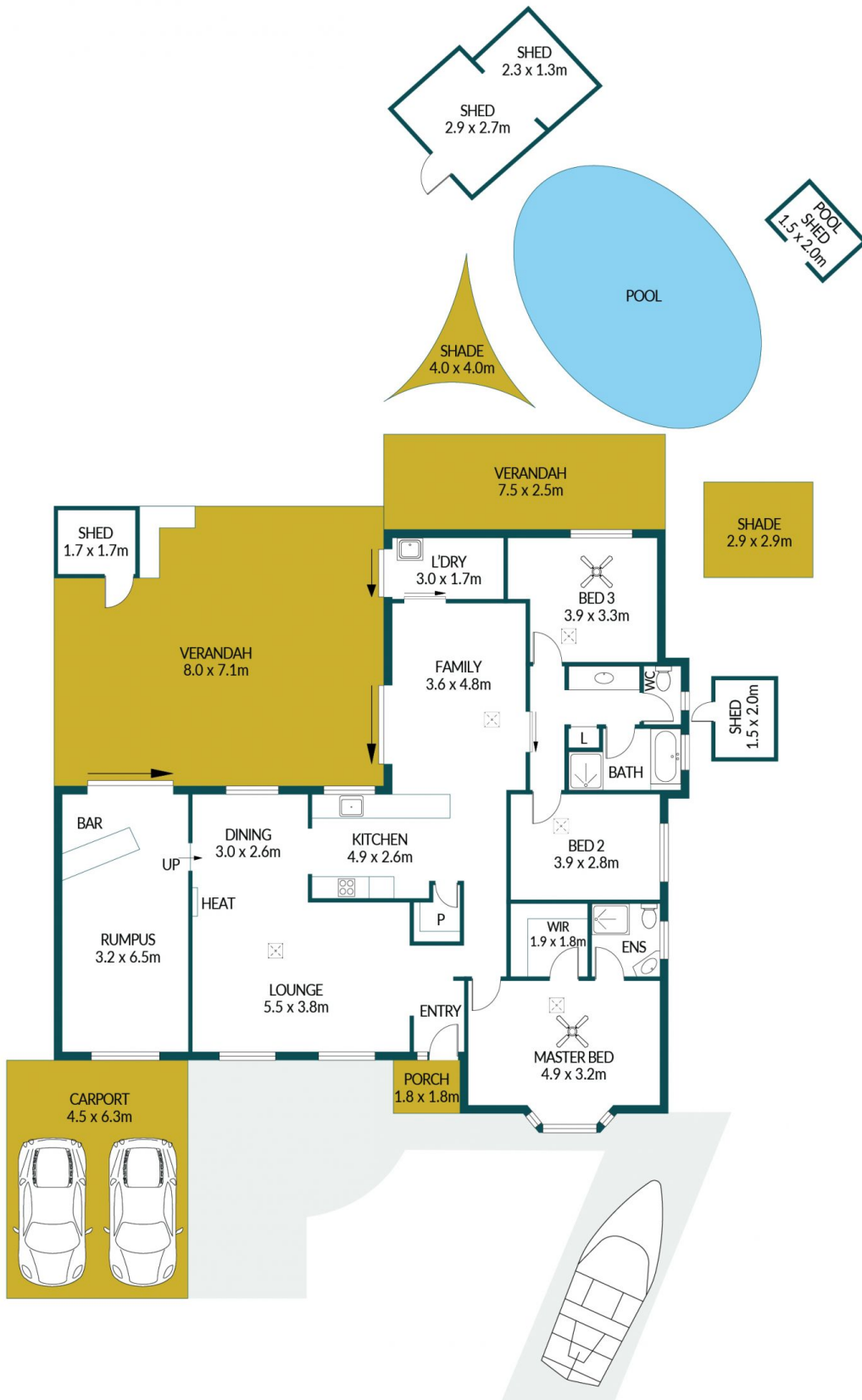

## 2 GREIG COURT, PARALOWIE

### Disclaimer

Plans shown are for marketing purposes only. All dimensions are approximate and not to scale. They are subject to errors and inaccuracies and no liability will be accepted. Interested parties should make their own enquiries. Inclusions and exclusions must be confirmed in the Residential Contract.

### APPROXIMATE DIMENSIONS

LIVING:	153.4m <sup>2</sup>
CARPORT/SHADE:	52.8m <sup>2</sup>
PORCH/SHED:	22.9m <sup>2</sup>
VERANDAH:	18.8m <sup>2</sup>
TOTAL:	247.9m <sup>2</sup>