



9 Fletcher Road ELIZABETH EAST SA

4 1 4

For an in-depth look at this home, please click on the 3D tour for a virtual walk-through or copy and paste this link into your browser

Virtual <https://my.matterport.com/show/?m=3q3j68Pdxoq> Tour Link:

To submit an offer, please copy and paste this link into your browser:
<https://www.edgerealty.com.au/buying/make-an-offer/>

Mike Lao, Brendon Ly and Edge Realty RLA256385 are proud to present to the market this impressive property at 9 Fletcher Road, Elizabeth East. Investors, downsizers, young families and renovators alike will love this property's location, subdivision potential (STCA) and large easement free block size. Currently tenanted with fantastic tenants, you'll be pleased to know that this property generates a

Price : \$ 475,000
Building Size : 107 sqm
Land Size : 919.4 sqm
View : <https://www.edgerealty.com.au/sale/sa/north-north-east-suburbs/elizabeth-east/residential/house/7629278>



Mike Lao
0410390250



Brendon Ly
0447888444

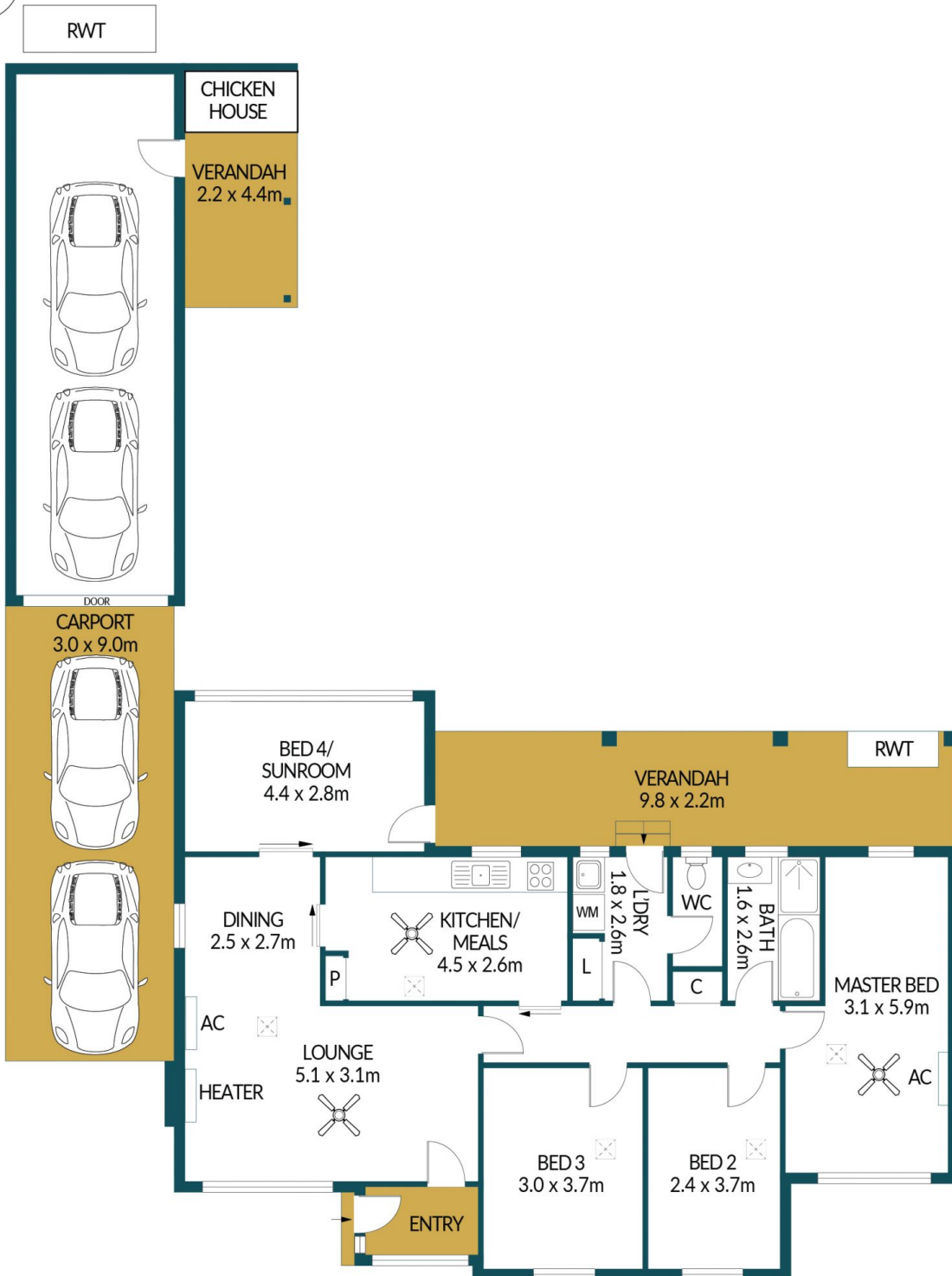

9 FLETCHER ROAD, ELIZABETH EAST

Disclaimer

Plans shown are for marketing purposes only. All dimensions are approximate and not to scale. They are subject to errors and inaccuracies and no liability will be accepted. Interested parties should make their own enquiries. Inclusions and exclusions must be confirmed in the Residential Contract.

APPROXIMATE DIMENSIONS

LIVING:	107.0m ²
GARAGE/CARPORT:	57.0m ²
VERANDAH:	9.6m ²
ENTERTAINING:	21.5m ²
TOTAL:	195.1m ²