

2 Lomond Street ANDREWS FARM SA

4 2 2

For an in-depth look at this home, please click on the 3D tour for a virtual walk-through or copy and paste this link into your browser

Virtual <https://my.matterport.com/show/?m=goiuRa6JEAD> Tour Link:

To submit an offer, please copy and paste this link into your browser:
<https://www.edgerealty.com.au/buying/make-an-offer/>

Mike Lao, Brendon Ly and Edge Realty RLA256385 are proud to present to the market this stylish modern haven that's ready for you to move in and relax. Families craving contemporary comfort, convenience and space will adore this gorgeous four-bedroom, two-bathroom home complete with spacious living areas and a long list of must-have features.

Price : \$ 527,100
Building Size : 141 sqm
Land Size : 514 sqm
View : <https://www.edgerealty.com.au/sale/sa/north-north-east-suburbs/andrews-farm/residential/house/7637483>



Mike Lao
0410390250



Brendon Ly
0447888444

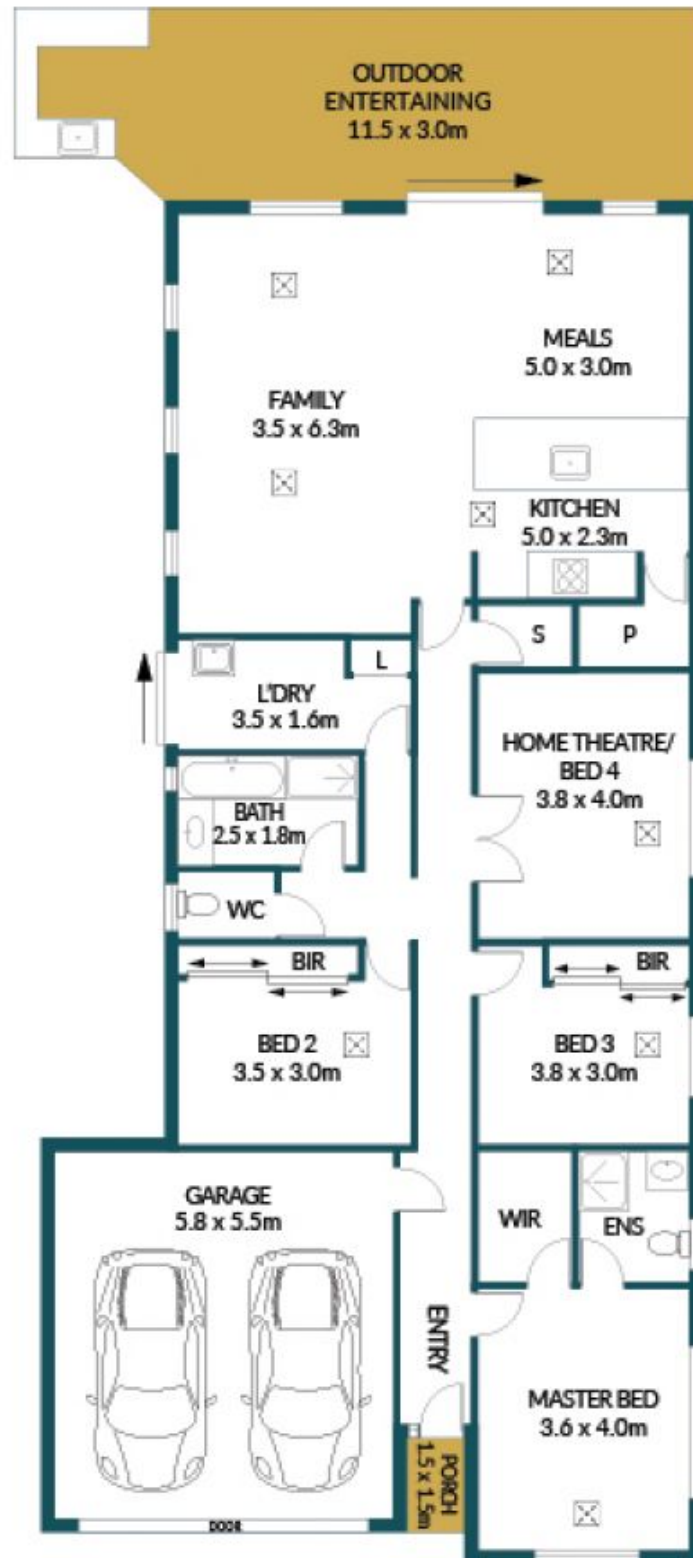

2 LOMOND STREET, ANDREWS FARM

Disclaimer

Plans shown are for marketing purposes only. All dimensions are approximate and not to scale. They are subject to errors and inaccuracies and no liability will be accepted. Interested parties should make their own enquiries. Inclusions and exclusions must be confirmed in the Residential Contract.

APPROXIMATE DIMENSIONS

| | |
|---------------|---------------------|
| LIVING: | 141.1m ² |
| GARAGE: | 31.9m ² |
| PORCH: | 2.3m ² |
| ENTERTAINING: | 34.5m ² |
| TOTAL: | 209.8m ² |