



12 Whitsbury Road ELIZABETH NORTH SA

3 1 1

For an in-depth look at this home, please click on the 3D tour for a virtual walk-through or copy and paste this link into your browser

Virtual Tour Link: <https://bit.ly/3O1GOju>

To submit an offer, please copy and paste this link into your browser:

<https://www.edgerealty.com.au/buying/make-an-offer/>

Mike Lao, Tyson Bennett and Edge Realty RLA256385 are proud to present to the market this 3 bedroom, 1 bathroom, residence located in the heart of Elizabeth North on a 891sqm block with loads of appeal for investors, developers and homeowners alike. The property is currently tenanted with a fixed lease of \$270 pw in place until 23/9/23.

Price : \$ 376,205
Building Size : 99 sqm
Land Size : 891 sqm
View : <https://www.edgerealty.com.au/sale/sa/north-north-east-suburbs/elizabeth-north/residential/house/7673272>



Mike Lao
0410390250



Tyson Bennett
0437161997

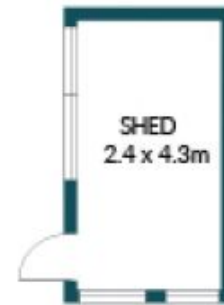

WT

*does not hold water

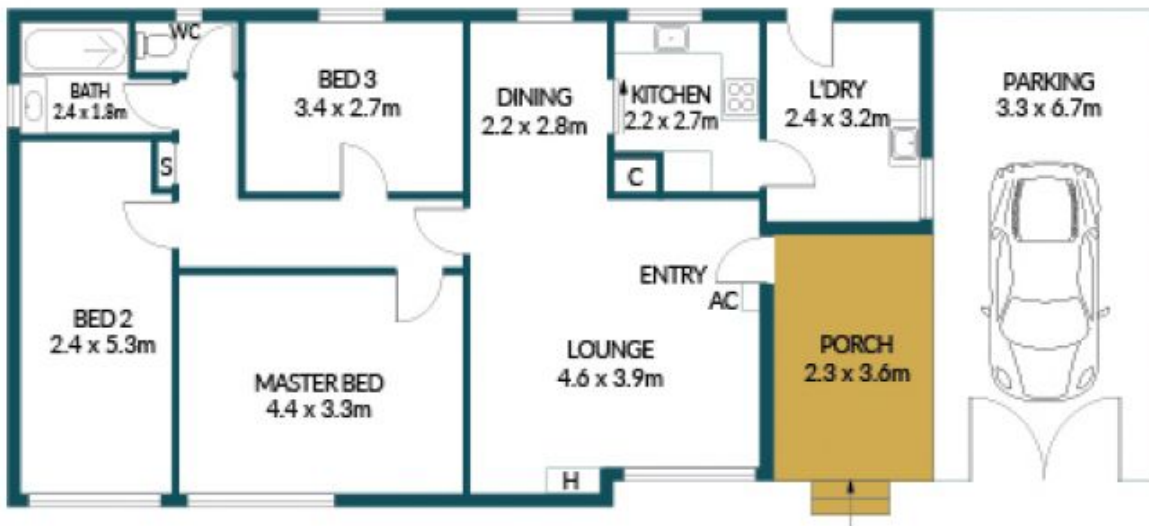

12 WHITSBURY ROAD, ELIZABETH NORTH

Disclaimer

Plans shown are for marketing purposes only. All dimensions are approximate and not to scale. They are subject to errors and inaccuracies and no liability will be accepted. Interested parties should make their own enquiries. Inclusions and exclusions must be confirmed in the Residential Contract.

APPROXIMATE DIMENSIONS

LIVING:	94.2m ²
GARAGE:	24.8m ²
PORCH/PARKING:	30.4m ²
SHED:	10.3m ²
TOTAL:	159.7m ²