



## 16 Crown Street GAWLER EAST SA

3 1 4

\*For an in-depth look at this home, please click on the 3D tour for a virtual walk-through or copy and paste this link into your browser\*

Virtual <https://my.matterport.com/show/?m=xyn9LxJnm9u> Tour Link:

To submit an offer, please copy and paste this link into your browser:  
<https://www.edgerealty.com.au/buying/make-an-offer/>

Mike Lao, Tyson Bennett and Edge Realty RLA256385 are proud to present to the market this spacious three-bedroom solid brick home situated on a massive 1,053sqm block and boasting multiple living spaces, dual driveways with space for your boat and caravan, a generously-sized backyard and much more! Situated in a peaceful pocket of Gawler East and within easy reach of all you need, this

**Price** : \$ 510,000  
**Building Size** : 110 sqm  
**Land Size** : 1053 sqm  
**View** : <https://www.edgerealty.com.au/sale/sa/north-north-east-suburbs/gawler-east/residential/house/7694760>



**Mike Lao**  
0410390250



**Tyson Bennett**  
0437161997

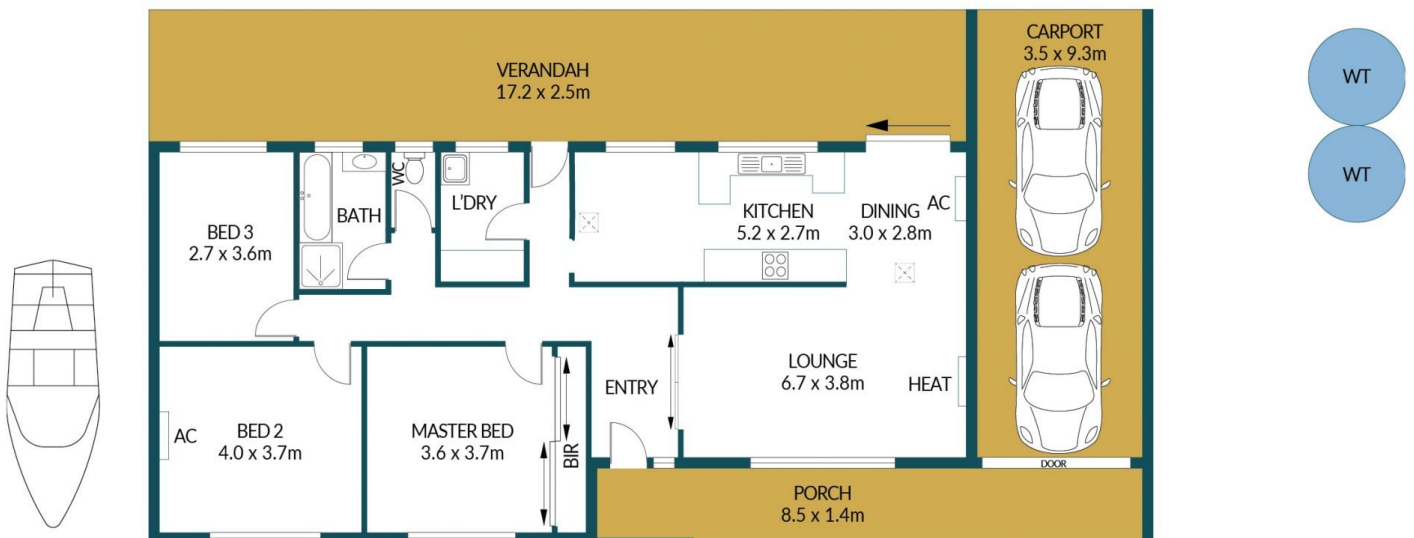
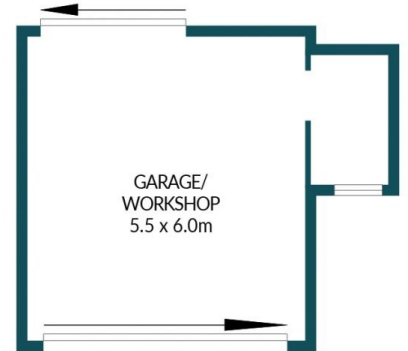
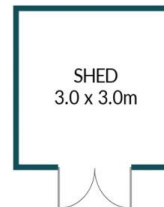

## 16 CROWN STREET, GAWLER EAST

### Disclaimer

Plans shown are for marketing purposes only. All dimensions are approximate and not to scale. They are subject to errors and inaccuracies and no liability will be accepted. Interested parties should make their own enquiries. Inclusions and exclusions must be confirmed in the Residential Contract.

APPROXIMATE DIMENSIONS	
LIVING:	110.8m <sup>2</sup>
WORKSHOP/CARPORT:	65.6m <sup>2</sup>
PORCH/CARAVAN:	18.9m <sup>2</sup>
VERANDAH/SHED:	52.0m <sup>2</sup>
TOTAL:	247.3m <sup>2</sup>