



## 38 Barker Crescent SMITHFIELD PLAINS SA

3 1 2

\*For an in-depth look at this home, please click on the 3D tour for a virtual walk-through or copy and paste this link into your browser\*

Virtual Tour Link: <https://shorturl.at/fhyzU>

To submit an offer, please copy and paste this link into your browser:

<https://www.edgerealty.com.au/buying/make-an-offer/>

Mike Lao, Tyson Bennett and Edge Realty RLA256385 are proud to present to the market this well-situated three-bedroom home standing proud on quiet cul-de-sac. With off street parking for multiple cars or your boat, and ample indoor spaces, this is a property perfect for those who love to entertain or work on their next home project.

You'll enter via a front porch into the open-plan lounge and

**Price** : \$ 380,000  
**Building Size** : 87 sqm  
**Land Size** : 620 sqm  
**View** : <https://www.edgerealty.com.au/sale/sa/north-north-east-suburbs/smithfield-plains/residential/house/7720138>



**Mike Lao**  
0410390250



**Tyson Bennett**  
0437161997

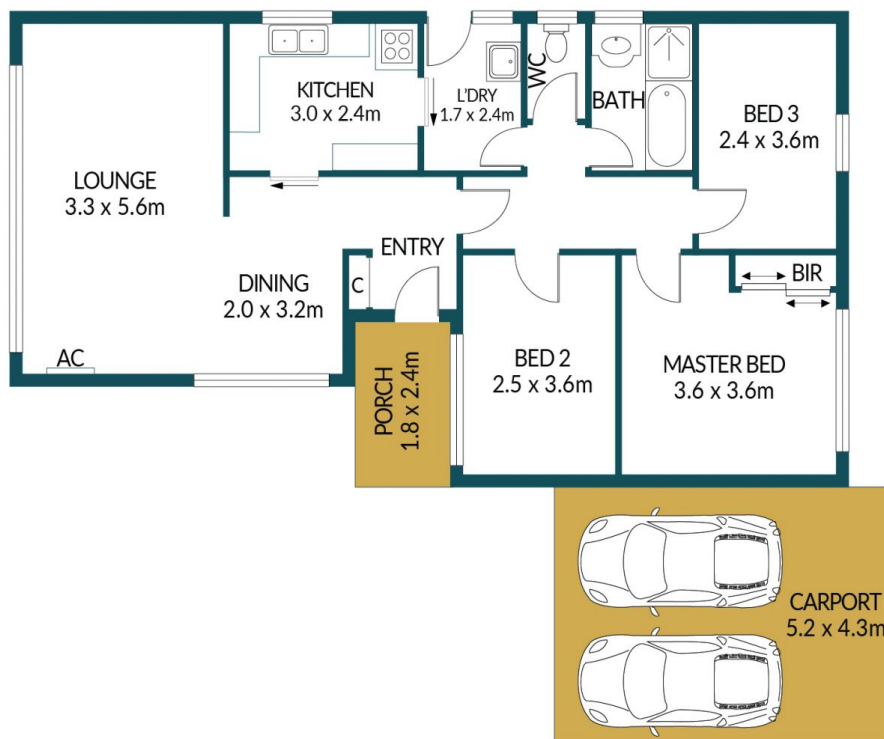

## 38 BARKER CRESCENT, SMITHFIELD PLAINS

### Disclaimer

Plans shown are for marketing purposes only. All dimensions are approximate and not to scale. They are subject to errors and inaccuracies and no liability will be accepted. Interested parties should make their own enquiries. Inclusions and exclusions must be confirmed in the Residential Contract.

APPROXIMATE DIMENSIONS	
LIVING:	87.0m <sup>2</sup>
CARPORT:	22.3m <sup>2</sup>
PORCH:	4.3m <sup>2</sup>
SHED:	11.1m <sup>2</sup>
TOTAL:	124.7m <sup>2</sup>