



68 Edward John Parade EYRE SA

4 2 2

For an in-depth look at this home, please click on the 3D tour for a virtual walk-through or copy and paste this link into your browser

Virtual <https://my.matterport.com/show/?m=VrNnohQw9dK> Tour Link:

To submit an offer, please copy and paste this link into your browser:
<https://www.edgerealty.com.au/buying/make-an-offer/>

Mike Lao, Tyson Bennett and Edge Realty RLA256385 are proud to present to the market this stylish and modern haven set within a contemporary family-friendly neighbourhood; there will be no shortage of buyers eager to secure this idyllic property. The layout is crafted to make the most of the easy-care block with a spacious four-bedroom, two-bathroom layout with multiple living

Price : \$ 620,500
Building Size : 168 sqm
Land Size : 517 sqm
View : <https://www.edgerealty.com.au/sale/sa/north-north-east-suburbs/eyre/residential/house/7744003>



Mike Lao
0410390250



Tyson Bennett
0437161997

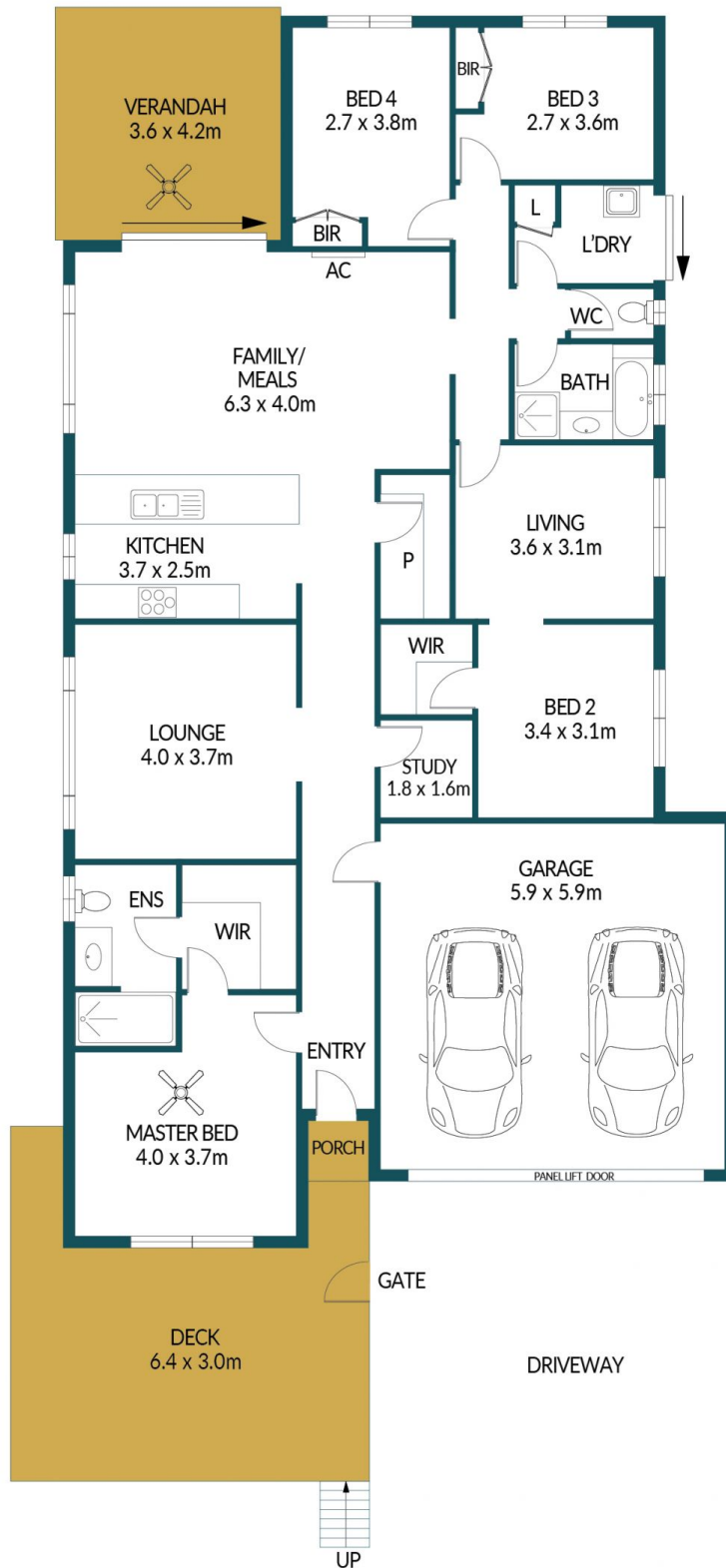

68 EDWARD JOHN PARADE, EYRE

Disclaimer

Plans shown are for marketing purposes only. All dimensions are approximate and not to scale. They are subject to errors and inaccuracies and no liability will be accepted. Interested parties should make their own enquiries. Inclusions and exclusions must be confirmed in the Residential Contract.

APPROXIMATE DIMENSIONS

LIVING:	168.9m ²
GARAGE:	34.8m ²
DECK:	19.2m ²
PORCH:	1.2m ²
VERANDAH:	15.1m ²
TOTAL:	239.2m ²