



31 Edith Road SALISBURY NORTH SA

3  1  1 

For an in-depth look at this home, please click on the 3D tour for a virtual walk-through or copy and paste this link into your browser

Virtual Tour Link: <https://shorturl.at/vEH19>

To submit an offer, please copy and paste this link into your browser:

<https://www.edgerealty.com.au/buying/make-an-offer/>

Mike Lao, Tyson Bennett and Edge Realty RLA256385 are proud to present to the market this glorious 3-bedroom property where a sought-after setting, sublime style and superior space all come together in one neat package to create a home you'll be proud to call your own.

Generously sized yet low-maintenance, the 607sqm block comes immaculately presented from front to back with a

Price : \$ 490,000
Building Size : 90 sqm
Land Size : 607 sqm
View : <https://www.edgerealty.com.au/sale/sa/north-north-east-suburbs/salisbury-north/residential/house/7749685>



Mike Lao
0410390250



Tyson Bennett
0437161997

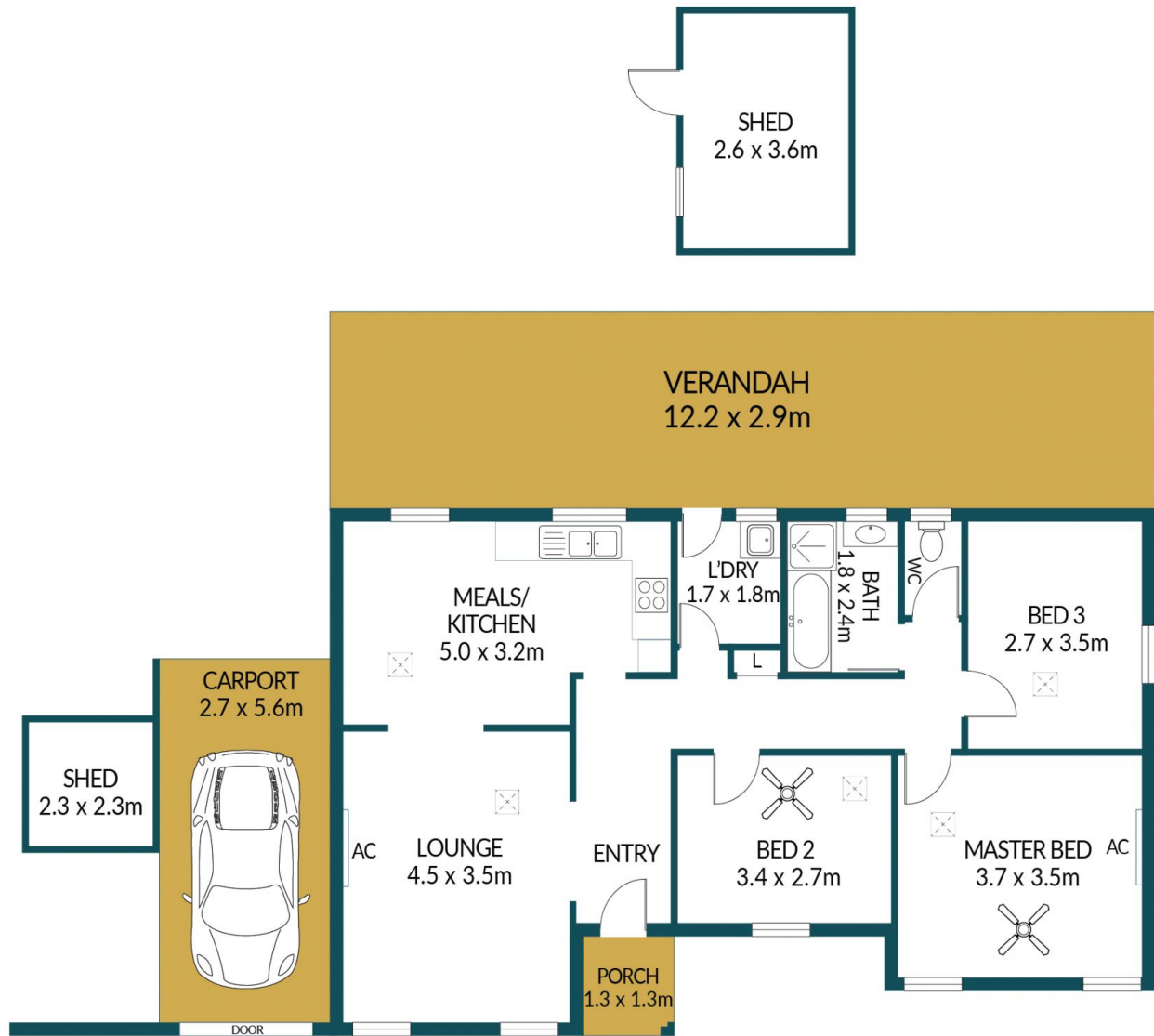

31 EDITH ROAD, SALISBURY NORTH

Disclaimer

Plans shown are for marketing purposes only. All dimensions are approximate and not to scale. They are subject to errors and inaccuracies and no liability will be accepted. Interested parties should make their own enquiries. Inclusions and exclusions must be confirmed in the Residential Contract.

APPROXIMATE DIMENSIONS

LIVING:	90.4m ²
CARPORT:	15.1m ²
PORCH/VERANDAH:	36.9m ²
SHED:	13.4m ²
TOTAL:	155.8m ²