



**1/27 Midway Road ELIZABETH EAST SA**

2 1 1

\*For an in-depth look at this home, please click on the 3D tour for a virtual walk-through or copy and paste this link into your browser\*

Virtual <https://my.matterport.com/show/?m=ju2ByC8g7JL> Tour Link:

To submit an offer, please copy and paste this link into your browser:  
<https://www.edgerealty.com.au/buying/make-an-offer/>

Mike Lao, Tyson Bennett and Edge Realty RLA256385 are proud to present to the market a downsizing delight awaiting the visionary investor. Set within a quiet group of two, this surprisingly spacious property boasts tastefully modern interiors, partially refurbished and ready for you to make the final touches!

**Price** : \$ 345,000  
**Building Size** : 72 sqm  
**View** : <https://www.edgerealty.com.au/sale/sa/north-north-east-suburbs/elizabeth-east/residential/house/7824341>



**Mike Lao**  
0410390250



**Tyson Bennett**  
0437161997

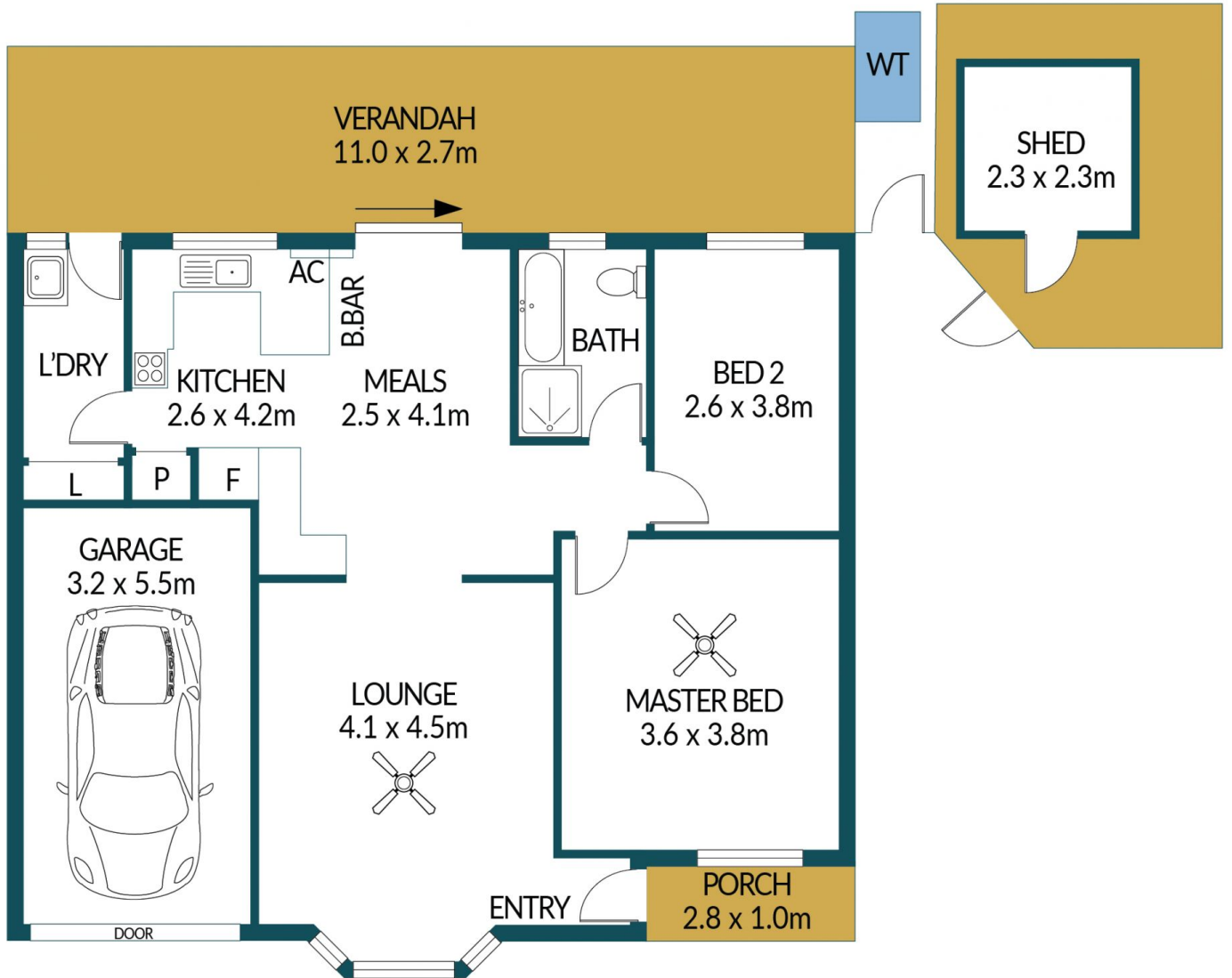

## 1/27 MIDWAY ROAD, ELIZABETH EAST

### Disclaimer

Plans shown are for marketing purposes only. All dimensions are approximate and not to scale. They are subject to errors and inaccuracies and no liability will be accepted. Interested parties should make their own enquiries. Inclusions and exclusions must be confirmed in the Residential Contract.

### APPROXIMATE DIMENSIONS

LIVING:	72.6m <sup>2</sup>
GARAGE:	17.6m <sup>2</sup>
PORCH/SHED:	8.1m <sup>2</sup>
VERANDAH:	29.7m <sup>2</sup>
TOTAL:	128.0m <sup>2</sup>