

## 46 Mahood Street ELIZABETH GROVE SA

3 1 3

To submit an offer, please copy and paste this link into your browser:

<https://www.edgerealty.com.au/buying/make-an-offer/>

Mike Lao, Brendon Ly and Edge Realty RLA256385 are proud to present to the market this easy-care home set within a peaceful locale offering a life of convenience. Situated on a 530sqm approx block, this three-bedroom, one-bathroom abode will delight first-time buyers, young families and downsizers alike. The property is currently tenanted on a fixed lease returning \$400 per week.

Please note photographs of the property were taken in 2017 and are being reused as the property is currently tenanted.

A vibrant front yard adds instant street appeal and

**Price** : \$ 385,000  
**Building Size** : 206 sqm  
**Land Size** : 530 sqm  
**View** : <https://www.edgerealty.com.au/sale/sa/north-north-east-suburbs/elizabeth-grove/residential/house/7831577>



**Mike Lao**  
0410390250



**Brendon Ly**  
0447888444



SHED

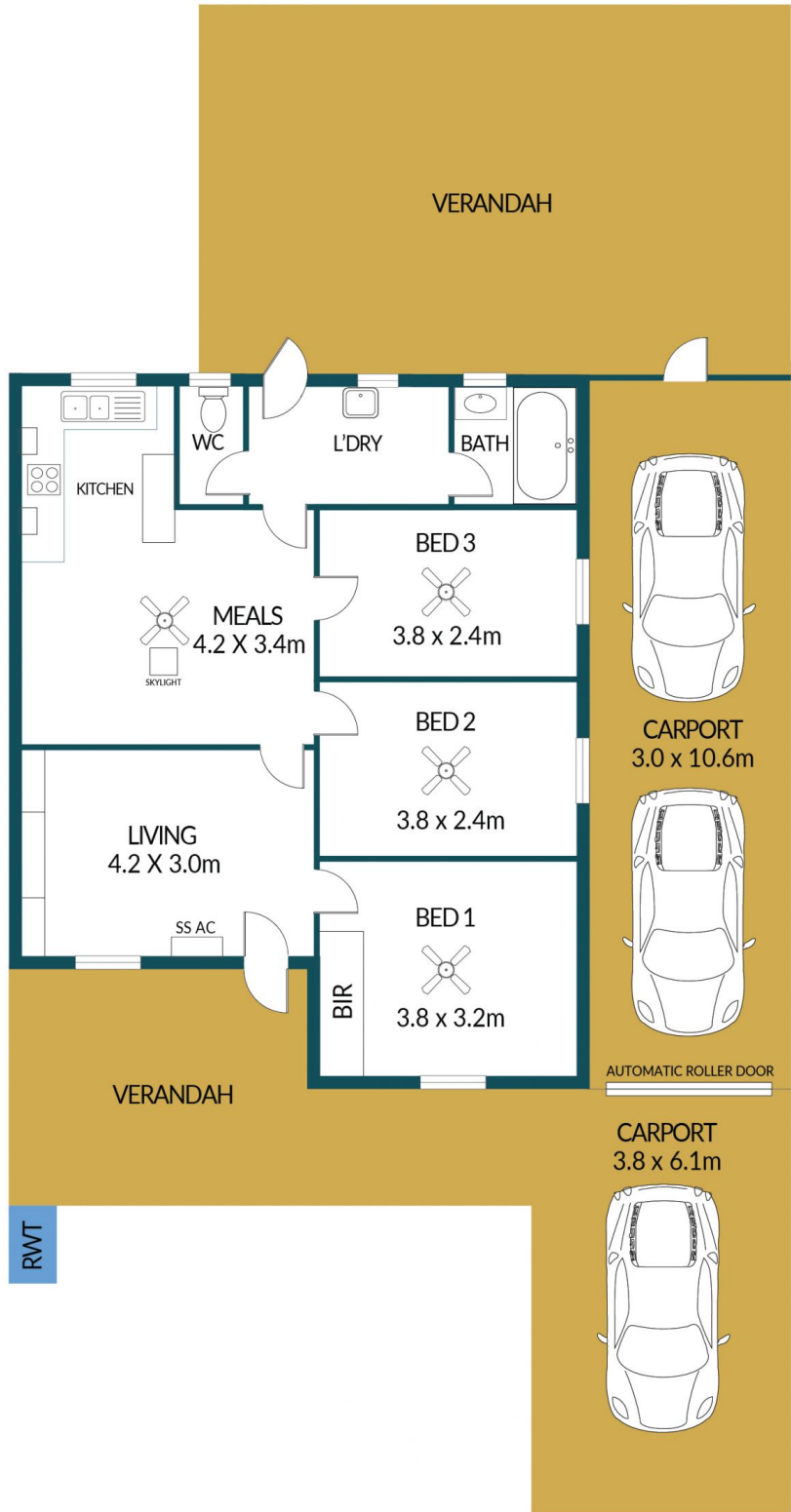

## 46 MAHOOD STREET, SMITHFIELD PLAINS

### Disclaimer

Plans shown are for marketing purposes only. All dimensions are approximate and not to scale. They are subject to errors and inaccuracies and no liability will be accepted. Interested parties should make their own enquiries. Inclusions and exclusions must be confirmed in the Residential Contract.

### APPROXIMATE DIMENSIONS

LIVING:	83.42m <sup>2</sup>
CARPORT:	54.98m <sup>2</sup>
VERANDAH:	67.94m <sup>2</sup>
TOTAL:	206.34m <sup>2</sup>