



## 6 Cooper Place ANGLE VALE SA

5 2 4

\*For an in-depth look at this home, please click on the 3D tour for a virtual walk-through or copy and paste this link into your browser\*

Virtual Tour Link:  
<https://my.matterport.com/show/?m=KM5C7hyzJHN>

To submit an offer, please copy and paste this link into your browser:  
<https://www.edgerealty.com.au/buying/make-an-offer/>

Mike Lao, Tyson Bennett and Edge Realty RLA256385 are proud to present to the market this picture-perfect family home set within a quiet, family-friendly court that's ready for you to move in and start making memories. From the beautiful street appeal with a brick facade and manicured lawns to the open-plan interior with ducted reverse cycle air-conditioning throughout, this is a spacious, flexible and

**Price** : \$ 755,000  
**Building Size** : 202 sqm  
**Land Size** : 690 sqm  
**View** : <https://www.edgerealty.com.au/sale/sa/north-north-east-suburbs/angle-vale/residential/house/7838515>



**Mike Lao**  
0410390250



**Tyson Bennett**  
0437161997

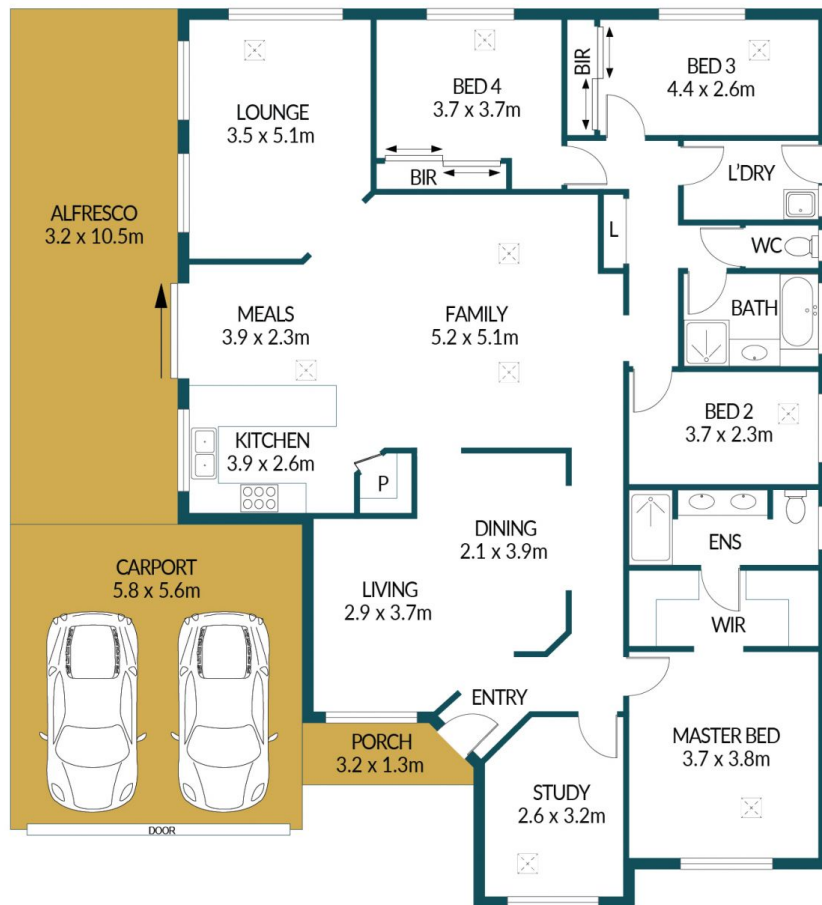
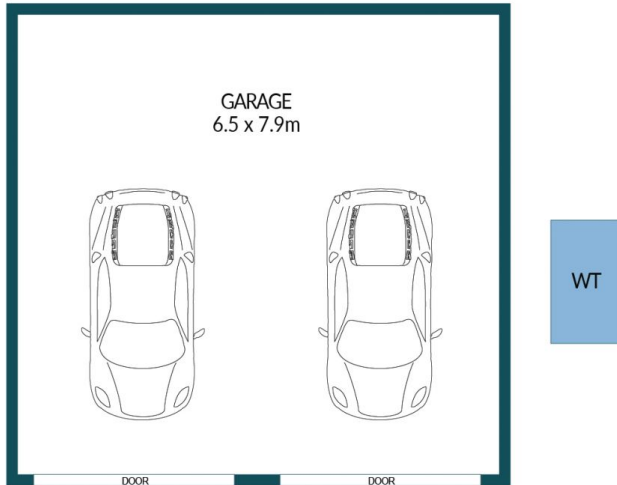

## 6 COOPER PLACE, ANGLE VALE

### Disclaimer

Plans shown are for marketing purposes only. All dimensions are approximate and not to scale. They are subject to errors and inaccuracies and no liability will be accepted. Interested parties should make their own enquiries. Inclusions and exclusions must be confirmed in the Residential Contract.

### APPROXIMATE DIMENSIONS

LIVING:	202.6m <sup>2</sup>
GARAGE:	51.4m <sup>2</sup>
PORCH/CARPORT:	39.8m <sup>2</sup>
ALFRESCO:	34.1m <sup>2</sup>
TOTAL:	327.9m <sup>2</sup>