



## 158 President Avenue ANDREWS FARM SA

4 2 2

\*For an in-depth look at this home, please click on the 3D tour for a virtual walk-through or copy and paste this link into your browser\*

Virtual <https://my.matterport.com/show/?m=fqtSAandRTF> Tour Link:

To submit an offer, please copy and paste this link into your browser:  
<https://www.edgerealty.com.au/buying/make-an-offer/>

Mike Lao, Brendon Ly and Edge Realty RLA256385 are proud to present to the market a stylish modern haven that's ready for you to move in and relax. Families craving contemporary comfort and convenience will adore this gorgeous four-bedroom, two-bathroom home complete with spacious living areas and a long list of must-have features ensuring there's nothing to do but move in and start making

**Price** : \$ 665,000  
**Land Size** : 474 sqm  
**View** : <https://www.edgerealty.com.au/sale/sa/north-north-east-suburbs/andrews-farm/residential/house/7875004>



**Mike Lao**  
0410390250



**Brendon Ly**  
0447888444

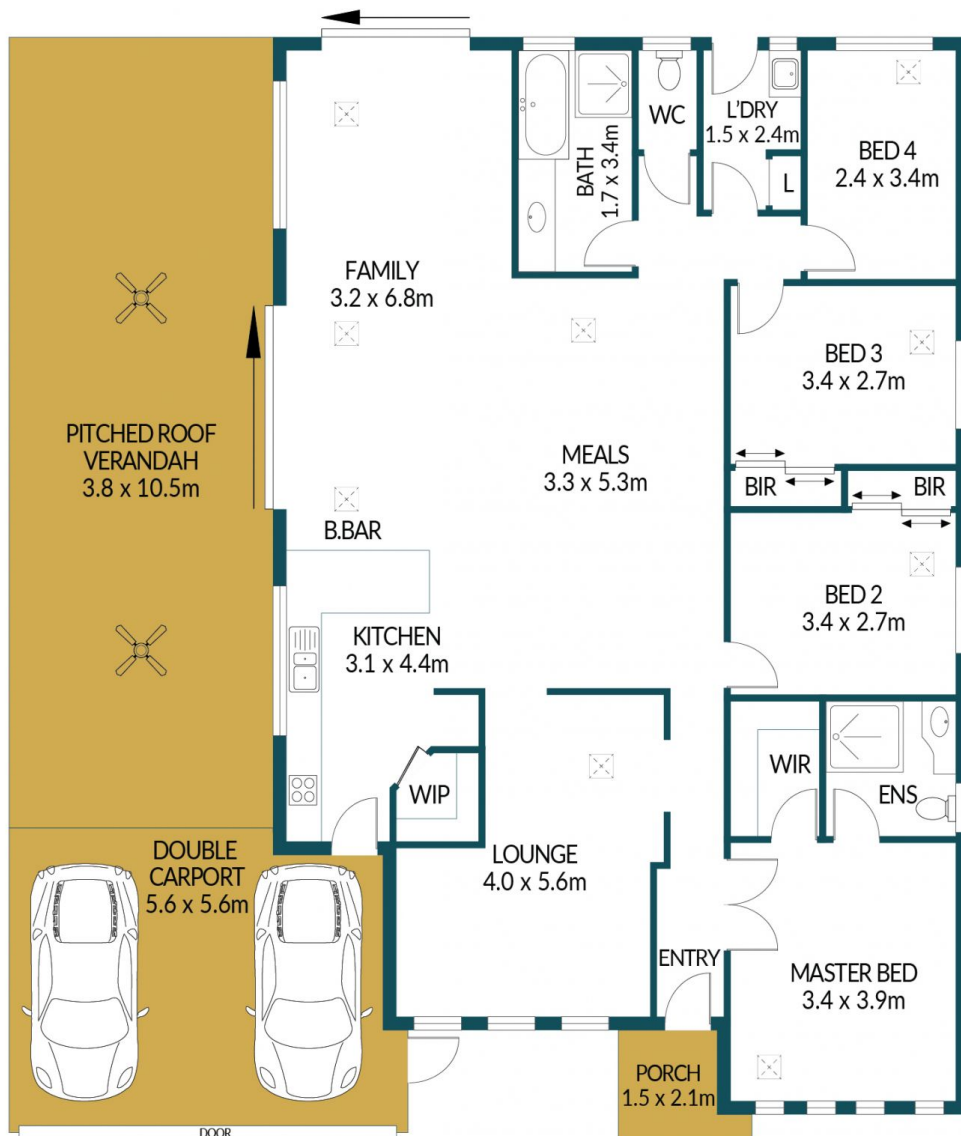
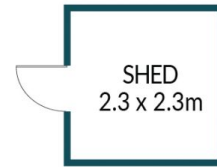

## 158 PRESIDENT AVENUE, ANDREWS FARM

### Disclaimer

Plans shown are for marketing purposes only. All dimensions are approximate and not to scale. They are subject to errors and inaccuracies and no liability will be accepted. Interested parties should make their own enquiries. Inclusions and exclusions must be confirmed in the Residential Contract.

### APPROXIMATE DIMENSIONS

LIVING:	163.2m <sup>2</sup>
DOUBLE CARPORT:	31.4m <sup>2</sup>
PORCH/SHED:	14.1m <sup>2</sup>
VERANDAH:	39.9m <sup>2</sup>
TOTAL:	248.6m <sup>2</sup>