



20 Degree Road SALISBURY NORTH SA

3 1 3

For an in-depth look at this home, please click on the 3D tour for a virtual walk-through or copy and paste this link into your browser

Virtual <https://my.matterport.com/show/?m=19z6xcyw1Li> Tour Link:

To submit an offer, please copy and paste this link into your browser:
<https://www.edgerealty.com.au/buying/make-an-offer/>

Mike Lao, Tyson Bennett and Edge Realty RLA256385 are proud to present to the market this solid brick family home that is ready for you to move in and start making memories. From the moment the front door opens, you will be struck by the abundance of soft natural light that floods the open space, inviting you to step inside and relax.

Price : \$ 555,000
Building Size : 112 sqm
Land Size : 750 sqm
View : <https://www.edgerealty.com.au/sale/sa/north-north-east-suburbs/salisbury-north/residential/house/7888272>



Mike Lao
0410390250



Tyson Bennett
0437161997

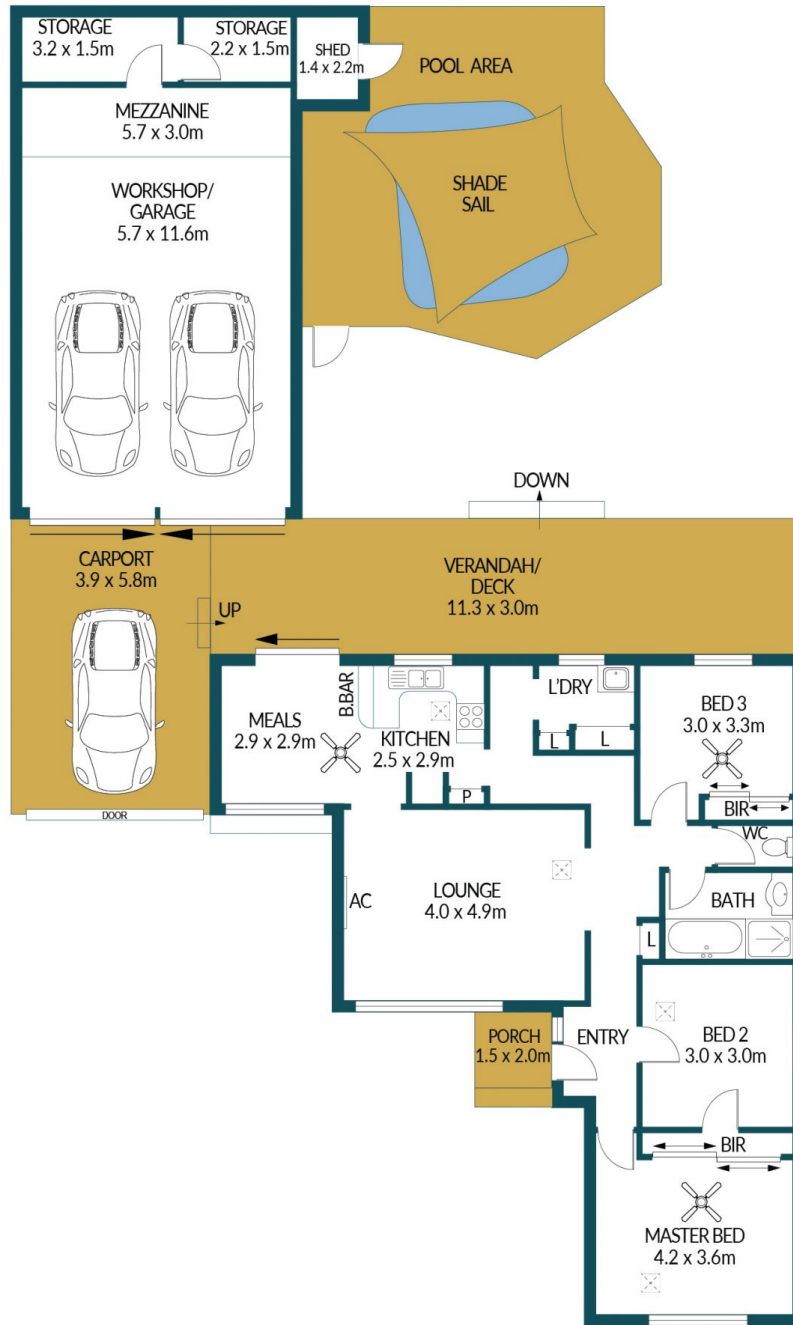

20 DEGREE ROAD, SALISBURY NORTH

Disclaimer

Plans shown are for marketing purposes only. All dimensions are approximate and not to scale. They are subject to errors and inaccuracies and no liability will be accepted. Interested parties should make their own enquiries. Inclusions and exclusions must be confirmed in the Residential Contract.

APPROXIMATE DIMENSIONS

LIVING:	95.3m ²
GARAGE/STORAGE:	66.1m ²
PORCH/DECK:	36.9m ²
CARPORT/SHED:	25.6m ²
TOTAL:	223.9m ²