



### 23 Adams Road ELIZABETH PARK SA

3  1  2 

\*For an in-depth look at this home, please click on the 3D tour for a virtual walk-through or copy and paste this link into your browser\*

Virtual Tour Link: <https://shorturl.at/kqGHT>

To submit an offer, please copy and paste this link into your browser:

<https://www.edgerealty.com.au/buying/make-an-offer/>

Mike Lao, Tyson Bennett and Edge Realty RLA256385 are proud to present to the market this easy-care home that's sure to appeal to a wide range of buyers. Looking to bolster your investment portfolio? The property is currently tenanted with a fixed lease of \$500 per week until 6/6/24. Whether you are a first home buyer or family looking for a place to call home or perhaps a savvy investor planning is to sit back and enjoy the return, now is the time to buy and

**Price** : \$ 500,000  
**Land Size** : 776 sqm  
**View** : <https://www.edgerealty.com.au/sale/sa/north-north-east-suburbs/elizabeth-park/residential/house/7896716>



**Mike Lao**  
0410390250



**Tyson Bennett**  
0437161997

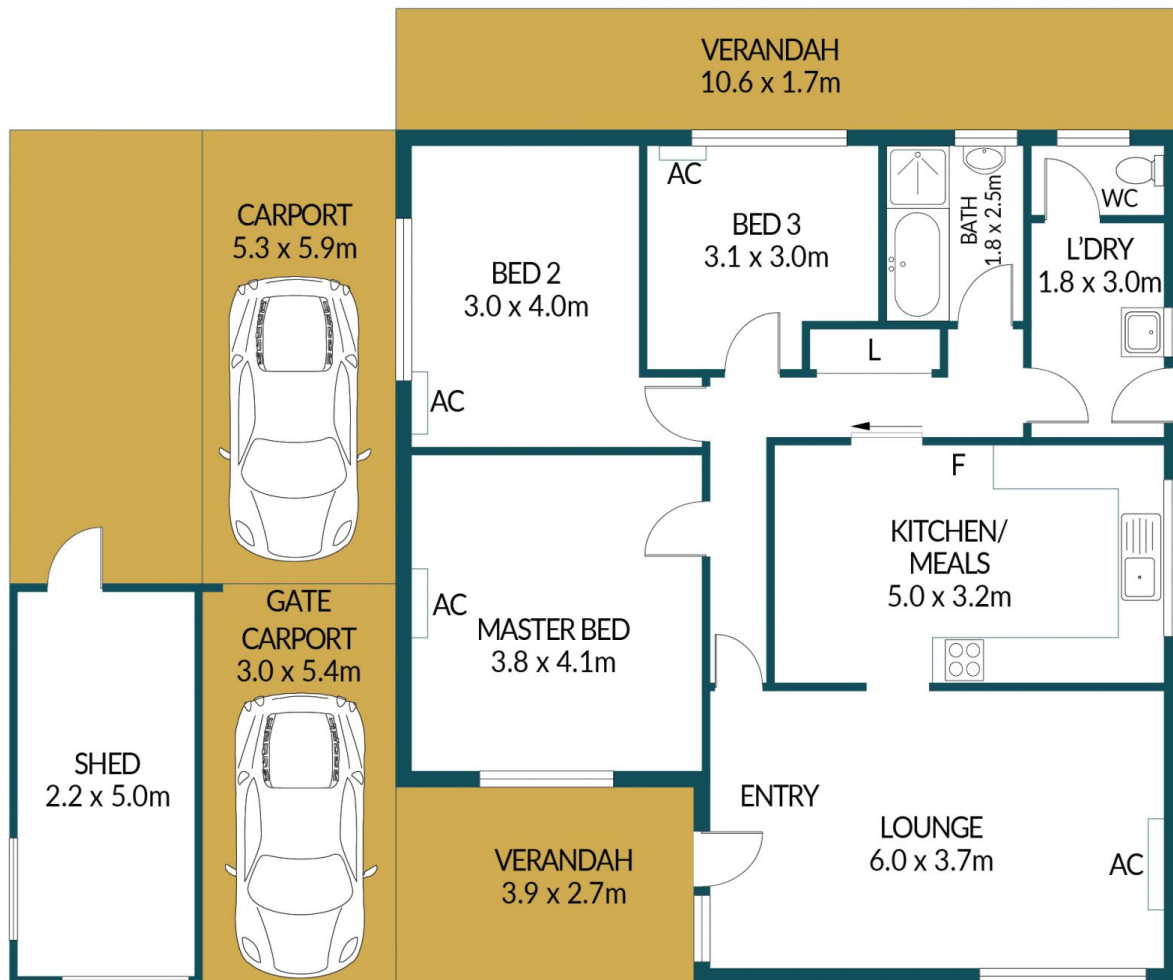

## 23 ADAMS ROAD, ELIZABETH PARK

### Disclaimer

Plans shown are for marketing purposes only. All dimensions are approximate and not to scale. They are subject to errors and inaccuracies and no liability will be accepted. Interested parties should make their own enquiries. Inclusions and exclusions must be confirmed in the Residential Contract.

### APPROXIMATE DIMENSIONS

LIVING:	100.6m <sup>2</sup>
SHED:	11.0m <sup>2</sup>
CARPORT:	27.6m <sup>2</sup>
VERANDAH:	24.1m <sup>2</sup>
TOTAL:	163.3m <sup>2</sup>