

## 12 Parnatti Street LIGHTSVIEW SA

3 2 1

\*For an in-depth look at this home, please click on the 3D tour for a virtual walk-through or copy and paste this link into your browser\*

Virtual Tour Link: <https://shorturl.at/btuDO>

To submit an offer, please copy and paste this link into your browser:

<https://www.edgerealty.com.au/buying/make-an-offer/>

Mike Lao, Tyson Bennett and Edge Realty RLA256385 are proud to present to the market this exceptional property that offers stylish and modern living in the vibrant region of Lightview. Perfectly suited for first home buyers, investors, and families, this property is a true gem that ticks all the boxes. The property is currently tenanted with a fixed lease of \$570 per week until 24/02/2025 for instant returns!

**Price** : \$ 605,000  
**Building Size** : 156 sqm  
**Land Size** : 132 sqm  
**View** : <https://www.edgerealty.com.au/sale/sa/north-north-east-suburbs/lightview/residential/townhouse/7905980>



**Mike Lao**  
0410390250



**Tyson Bennett**  
0437161997

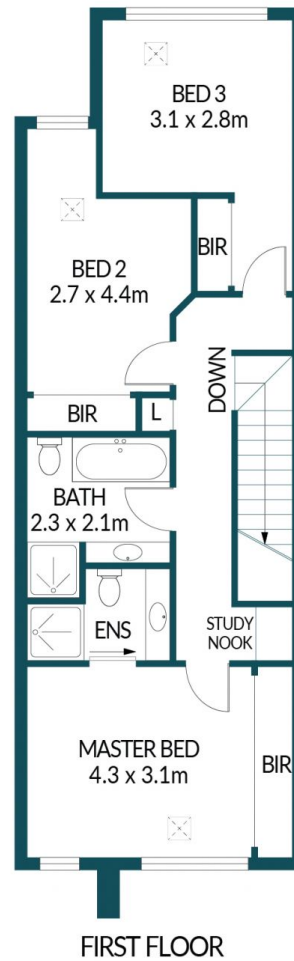
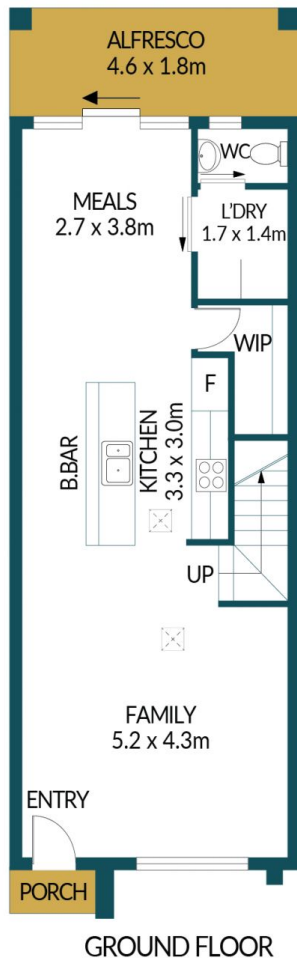
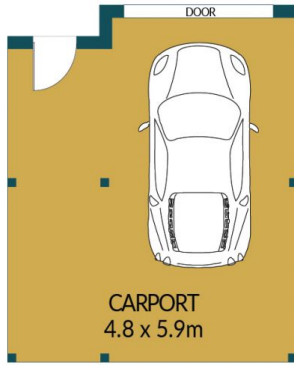

## 12 PARNATTI STREET, LIGHTSVIEW

### Disclaimer

Plans shown are for marketing purposes only. All dimensions are approximate and not to scale. They are subject to errors and inaccuracies and no liability will be accepted. Interested parties should make their own enquiries. Inclusions and exclusions must be confirmed in the Residential Contract.

### APPROXIMATE DIMENSIONS

LIVING:	117.8m <sup>2</sup>
CARPORT:	28.3m <sup>2</sup>
PORCH:	1.1m <sup>2</sup>
ALFRESCO:	8.3m <sup>2</sup>
TOTAL:	155.5m <sup>2</sup>