



10 Green Street ELIZABETH PARK SA

3 1 1

For an in-depth look at this home, please click on the 3D tour for a virtual walk-through or copy and paste this link into your browser

Virtual Tour Link: <https://shorturl.at/tIT67>

To submit an offer, please copy and paste this link into your browser:

<https://www.edgerealty.com.au/buying/make-an-offer/>

Tyson Bennett, Mike Lao and Edge Realty RLA256385 are proud to present to the market this light and bright semi-detached home located on an ideal corner block in Elizabeth Park. The functional floorplan will appeal to families craving contemporary comfort while investors will be drawn to the prime location and easy-care appeal of this impressive abode. The property is currently tenanted with a fixed lease of \$320 per week in place until 26/2/2025.

Price : \$ 340,000
Building Size : 68 sqm
Land Size : 450 sqm
View : <https://www.edgerealty.com.au/sale/sa/north-north-east-suburbs/elizabeth-park/residential/house/7915966>



Tyson Bennett
0437161997



Mike Lao
0410390250

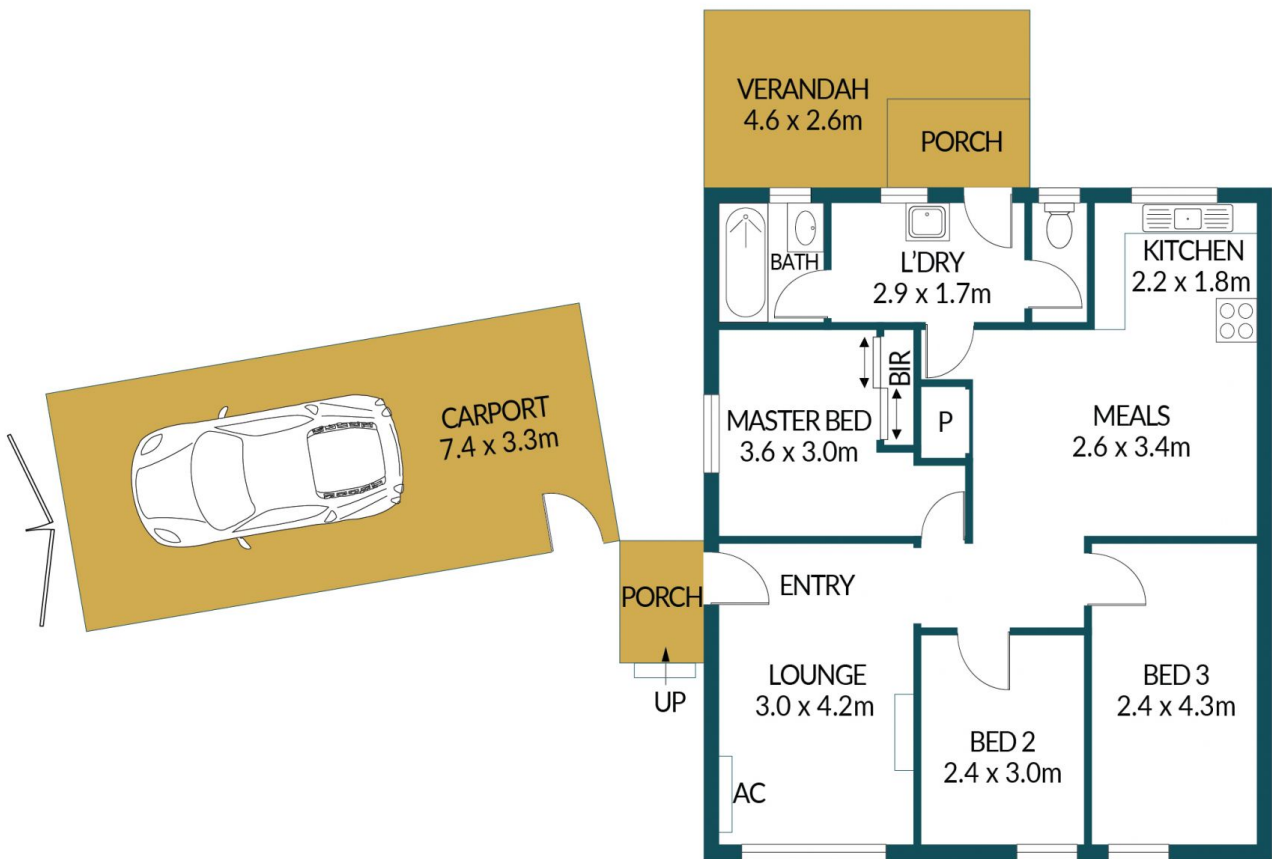
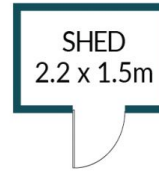

10 GREEN STREET, ELIZABETH PARK

Disclaimer

Plans shown are for marketing purposes only. All dimensions are approximate and not to scale. They are subject to errors and inaccuracies and no liability will be accepted. Interested parties should make their own enquiries. Inclusions and exclusions must be confirmed in the Residential Contract.

APPROXIMATE DIMENSIONS

LIVING:	68.0m ²
CARPORT:	24.4m ²
PORCH/VERANDAH:	14.5m ²
SHED:	3.3m ²
TOTAL:	110.2m ²