



## 9 Kelsey Road SALISBURY NORTH SA

2 1 1

\*For an in-depth look at this home, please click on the 3D tour for a virtual walk-through or copy and paste this link into your browser\*

Virtual <https://my.matterport.com/show/?m=noxBB5NxDhS> Tour Link:

To submit an offer, please copy and paste this link into your browser:  
<https://www.edgerealty.com.au/buying/make-an-offer/>

Mike Lao, Tyson Bennett and Edge Realty RLA256385 are proud to present to the market this charming abode that's perfectly suited to first-time buyers, downsizers and discerning investors alike.

A quaint, rendered facade and landscaped garden provide the ideal welcome to your new home with a covered

**Price** : \$ 393,500  
**Building Size** : 70 sqm  
**Land Size** : 515 sqm  
**View** : <https://www.edgerealty.com.au/sale/sa/north-north-east-suburbs/salisbury-north/residential/house/7929914>



**Mike Lao**  
0410390250



**Tyson Bennett**  
0437161997

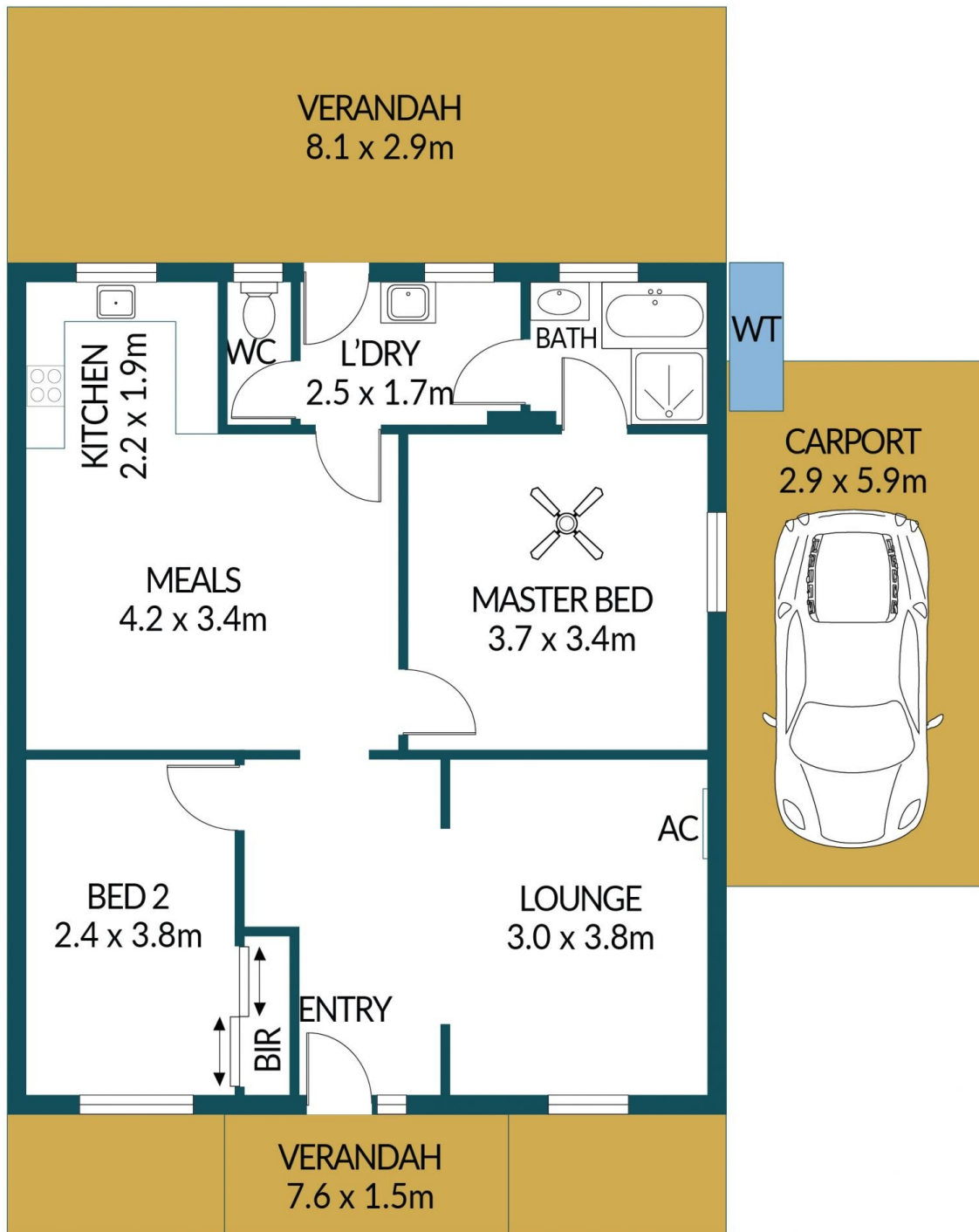

## 9 KELSEY ROAD, SALISBURY NORTH

### Disclaimer

Plans shown are for marketing purposes only. All dimensions are approximate and not to scale. They are subject to errors and inaccuracies and no liability will be accepted. Interested parties should make their own enquiries. Inclusions and exclusions must be confirmed in the Residential Contract.

### APPROXIMATE DIMENSIONS

LIVING:	70.0m <sup>2</sup>
CARPORT:	17.1m <sup>2</sup>
PORCH:	4.4m <sup>2</sup>
VERANDAH:	23.5m <sup>2</sup>
TOTAL:	115.0m <sup>2</sup>