



266 Peachey Road SMITHFIELD PLAINS SA

3 1 2

For an in-depth look at this home, please click on the 3D tour for a virtual walk-through or copy and paste this link into your browser

Virtual Tour Link:
<https://my.matterport.com/show/?m=iJXajYCM2gJ>

To submit an offer, please copy and paste this link into your browser:
<https://www.edgerealty.com.au/buying/make-an-offer/>

Mike Lao, Brendon Ly and Edge Realty RLA256385 are proud to present to the market this exceptional property that offers stylish and modern living. From the crisp neutral colour palette to the open-plan layout and natural light, this is a home that invites you to sit back, relax and enjoy a life of leisure, perfectly suited for first home buyers, investors, and families, this property is a true gem that ticks all the

Price : \$ 500,000
Building Size : 99 sqm
Land Size : 136 sqm
View : <https://www.edgerealty.com.au/sale/sa/north-north-east-suburbs/smithfield-plains/residential/house/7965574>



Mike Lao
0410390250



Brendon Ly
0447888444

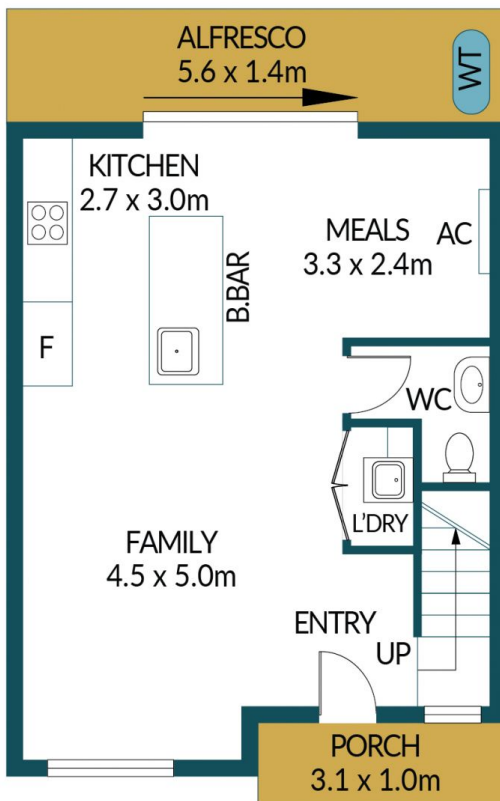
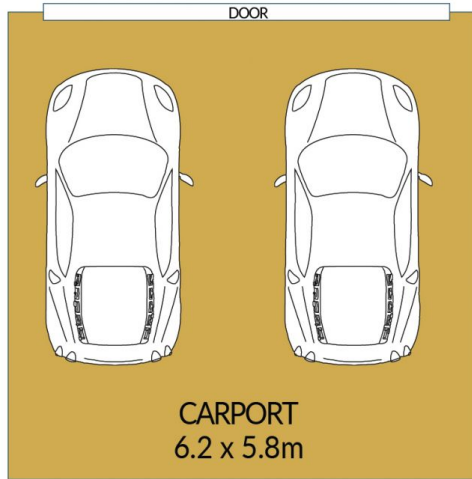

GROUND FLOOR

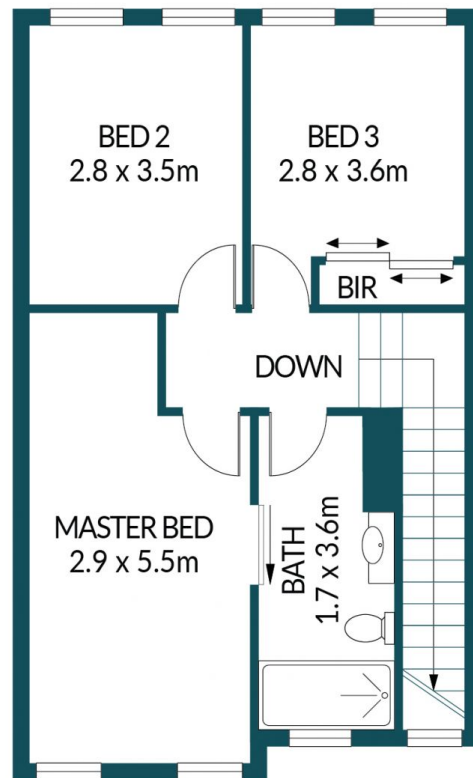

FIRST FLOOR

266 PEACHEY ROAD, SMITHFIELD PLAINS

Disclaimer

Plans shown are for marketing purposes only. All dimensions are approximate and not to scale. They are subject to errors and inaccuracies and no liability will be accepted. Interested parties should make their own enquiries. Inclusions and exclusions must be confirmed in the Residential Contract.

APPROXIMATE DIMENSIONS

LIVING:	99.9m ²
CARPORT:	35.9m ²
ALFRESCO:	7.8m ²
PORCH:	3.1m ²
TOTAL:	146.7m ²