



28 Heidenreich Avenue SALISBURY DOWNS SA

3 1 2

For an in-depth look at this home, please click on the 3D tour for a virtual walk-through or copy and paste this link into your browser

Virtual Tour Link:
<https://my.matterport.com/show/?m=U4XTwp6YjD8>

To submit an offer, please copy and paste this link into your browser:
<https://www.edgerealty.com.au/buying/make-an-offer/>

Mike Lao, Tyson Bennett and Edge Realty RLA256385 are proud to present to the market this idyllic corner block home that is ready to be customised to create your ideal living space. Nestled on a generous 864sqm block with no easements, this 3-bedroom, 1-bathroom brick home is bursting with promise and will appeal to a wide range of buyers including first home buyers, savvy investors, and

Price : \$ 630,000
Building Size : 97 sqm
Land Size : 864 sqm
View : <https://www.edgerealty.com.au/sale/sa/north-north-east-suburbs/salisbury-downs/residential/house/7986722>



Mike Lao
0410390250



Tyson Bennett
0437161997

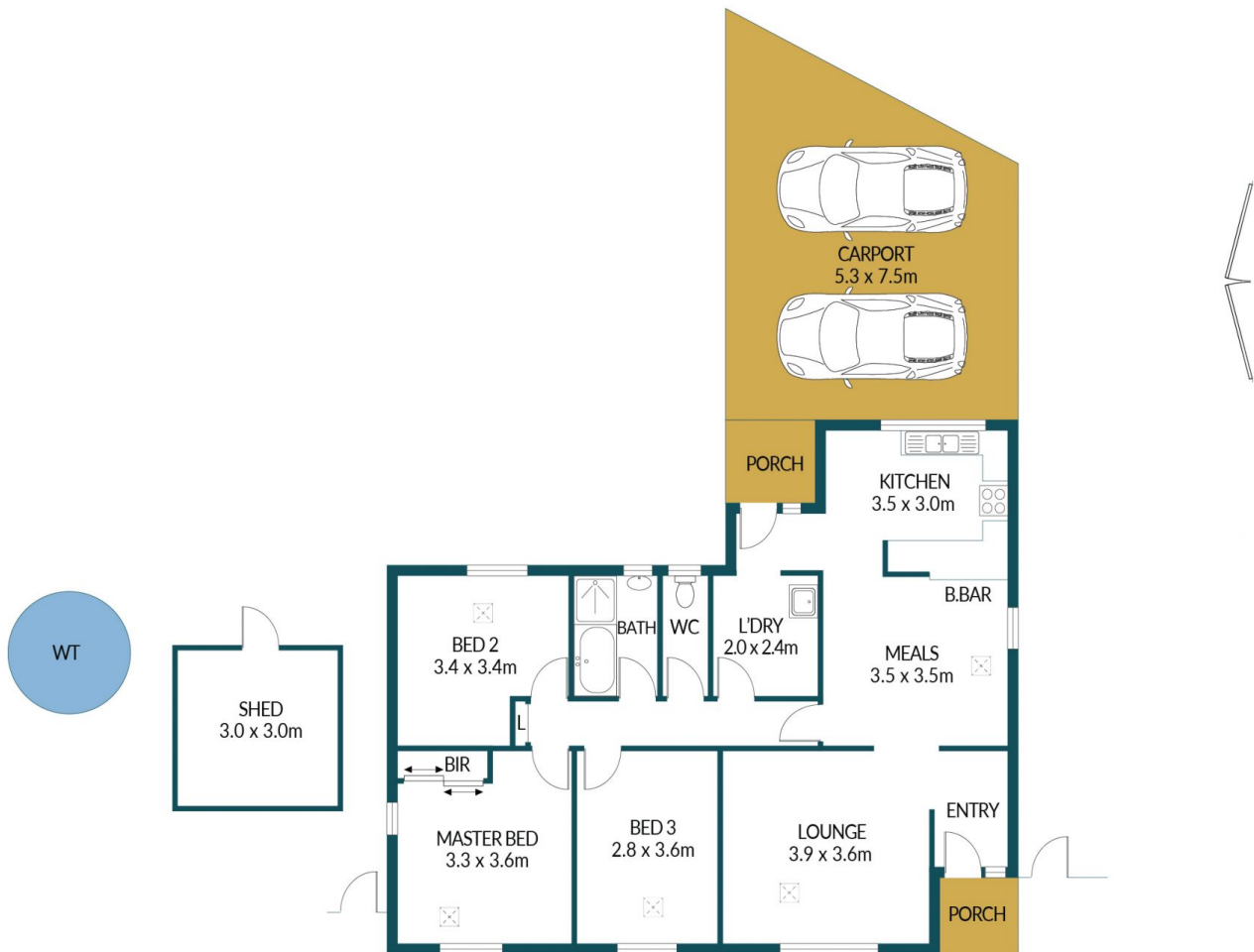

28 HEIDENREICH AVENUE, SALISBURY DOWNS

Disclaimer

Plans shown are for marketing purposes only. All dimensions are approximate and not to scale. They are subject to errors and inaccuracies and no liability will be accepted. Interested parties should make their own enquiries. Inclusions and exclusions must be confirmed in the Residential Contract.

APPROXIMATE DIMENSIONS

LIVING:	97.3m ²
CARPORT:	37.5m ²
PORCH:	5.5m ²
SHED:	9.0m ²
TOTAL:	149.3m ²