



## 19 Leicester Grove ANDREWS FARM SA

4 1 2

\*For an in-depth look at this home, please click on the 3D tour for a virtual walk-through or copy and paste this link into your browser\*

Virtual Tour Link:  
<https://my.matterport.com/show/?m=ydLedipihKW>

To submit an offer, please copy and paste this link into your browser:  
<https://www.edgerealty.com.au/buying/make-an-offer/>

Mike Lao, Brendon Ly and Edge Realty RLA256385 are proud to present to the market this delightful 3 bedroom abode in the sought after suburb of Andrews Farm. Set on a generous 570sqm easement free block, this property is ready for a growing family or those who simply want room

[For full version visit the website](https://www.edgerealty.com.au)

**Type** : House  
**Price** : \$ 655,000  
**Building Size** : 109 sqm  
**Land Size** : 570 sqm  
**View** : <https://www.edgerealty.com.au/sale/sa/north-north-east-suburbs/andrews-farm/residential/house/8148235>



**Mike Lao**  
 0419309350



**Brendon Ly**  
 0417889444

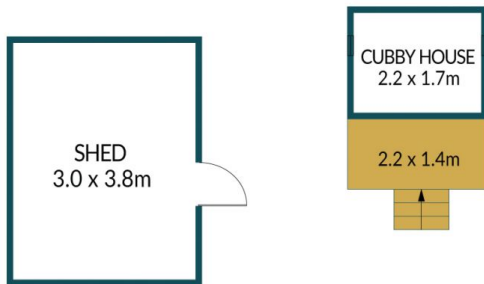

RWT

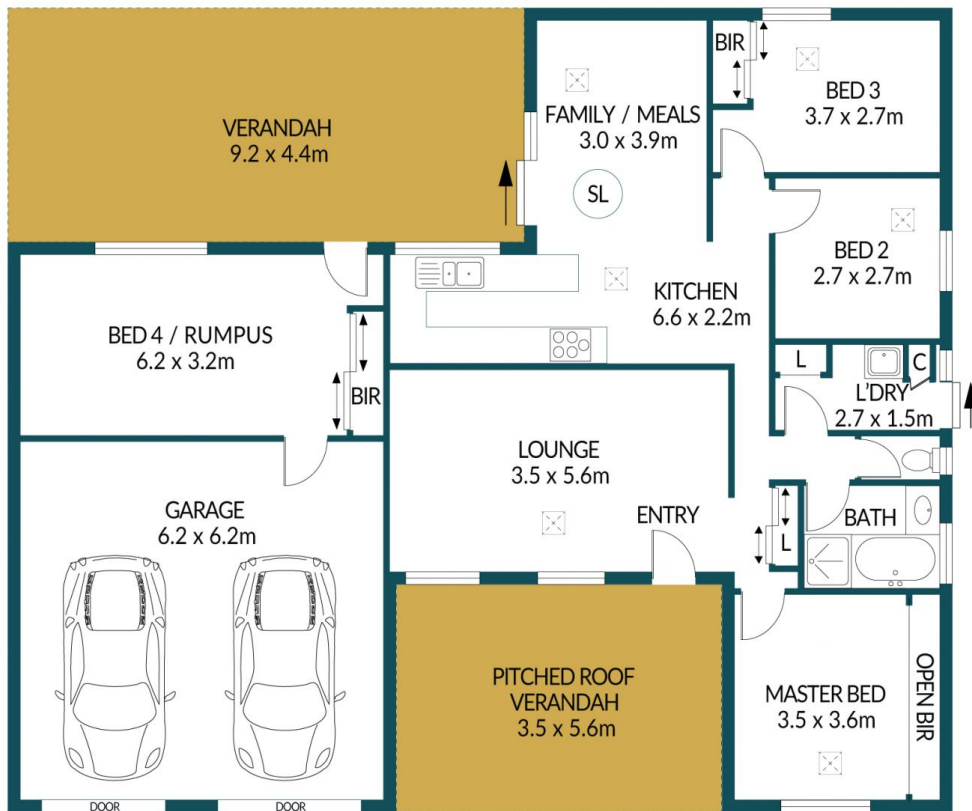

## 19 LEICESTER GROVE, ANDREWS FARM

### Disclaimer

Plans shown are for marketing purposes only. All dimensions and placements are approximate and not to scale. They are subject to errors and inaccuracies and no liability will be accepted. Interested parties should make their own enquiries. Inclusions and exclusions must be confirmed in the Residential Contract.

### APPROXIMATE DIMENSIONS

LIVING:	109.2m <sup>2</sup>
GARAGE:	38.4m <sup>2</sup>
VERANDAH:	60.1m <sup>2</sup>
SHED/CUBBY HOUSE:	15.1m <sup>2</sup>
TOTAL:	222.8m <sup>2</sup>