



## 21 Whitford Road ELIZABETH SOUTH SA

3 1 1

Develop, Invest or Nest on a 966sqm approx Allotment!

\*For an in-depth look at this home, please click on the 3D tour for a virtual walk-through or copy and paste this link into your browser\*

Virtual Tour Link:  
<https://my.matterport.com/show/?m=TxTh3QiQ7kk>

To submit an offer, please copy and paste this link into your browser:  
<https://www.edgerealty.com.au/buying/make-an-offer/>

Mike Lao, Joshua Boyd and Edge Realty RLA256385 are proud to present to the market a fantastic opportunity set on a generous 966sqm (approx) allotment, offering space,

[For full version visit the website](https://www.edgerealty.com.au)

**Type** : House  
**Price** : Contact Agent  
**Building Size** : 134 sqm  
**Land Size** : 966 sqm  
**View** : <https://www.edgerealty.com.au/sale/sa/north-north-east-suburbs/elizabeth-south/residential/house/8617418>



**Mike Lao**  
0410 200 250



**Joshua Boyd**  
0497889178

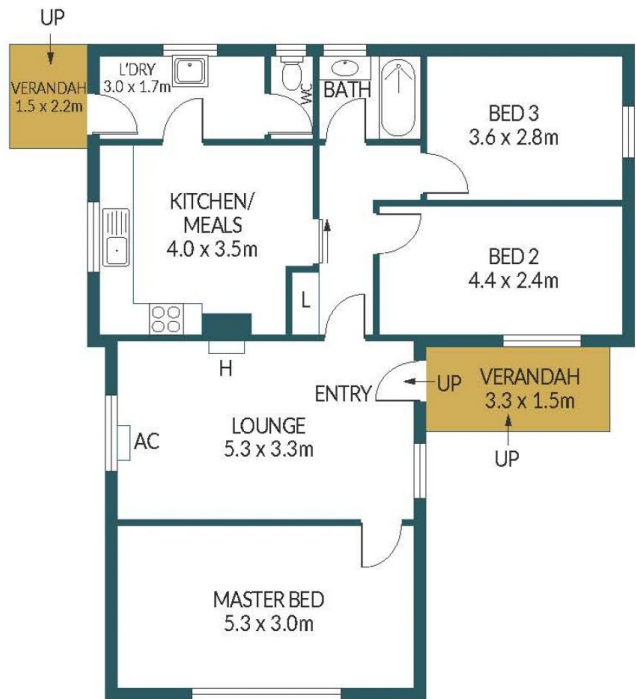
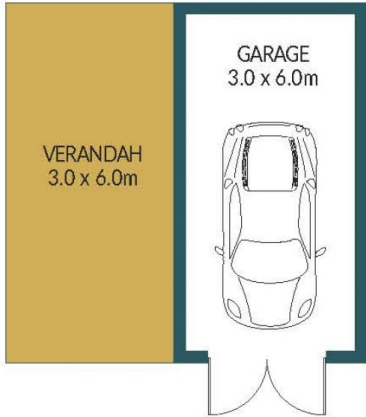

# 21 WHITFORD ROAD, ELIZABETH SOUTH



**Disclaimer**

Plans shown are for marketing purposes only. All dimensions and placements are approximate and not to scale. They are subject to errors and inaccuracies and Edge Realty will not accept any liability. Interested parties should make their own enquiries. Inclusions and exclusions must be confirmed in the Edge Realty Residential Contract.

**APPROXIMATE DIMENSIONS**

LIVING:	84.9m <sup>2</sup>
GARAGE:	18.0m <sup>2</sup>
VERANDAH/BALI HUT:	32.0m <sup>2</sup>
TOTAL:	134.9m <sup>2</sup>