



50 Mahood Street ELIZABETH GROVE SA

2 1 1

For an in-depth look at this home, please click on the 3D tour for a virtual walk-through or copy and paste this link into your browser

Virtual <https://my.matterport.com/show/?m=iQVe5iLBrgA> Tour Link:

To submit an offer, please copy and paste this link into your browser:
<https://www.edgerealty.com.au/buying/make-an-offer/>

Mike Lao, Brendon Ly and Edge Realty RLA256385 are proud to present to the market a neat and tidy two bedroom maisonette that blends classic charm with modern updates, set on a fully fenced 503sqm (approx) allotment. Recently refreshed and ready to move straight in or rent out, this is

[For full version visit the website](https://www.edgerealty.com.au)

Type : House
Price : \$570,000 - \$620,000
Building Size : 73 sqm
Land Size : 503 sqm
View : <https://www.edgerealty.com.au/sale/sa/north-north-east-suburbs/elizabeth-grove/residential/house/8685198>



Mike Lao
0419 299 259



Brendon Ly
0417 888 111

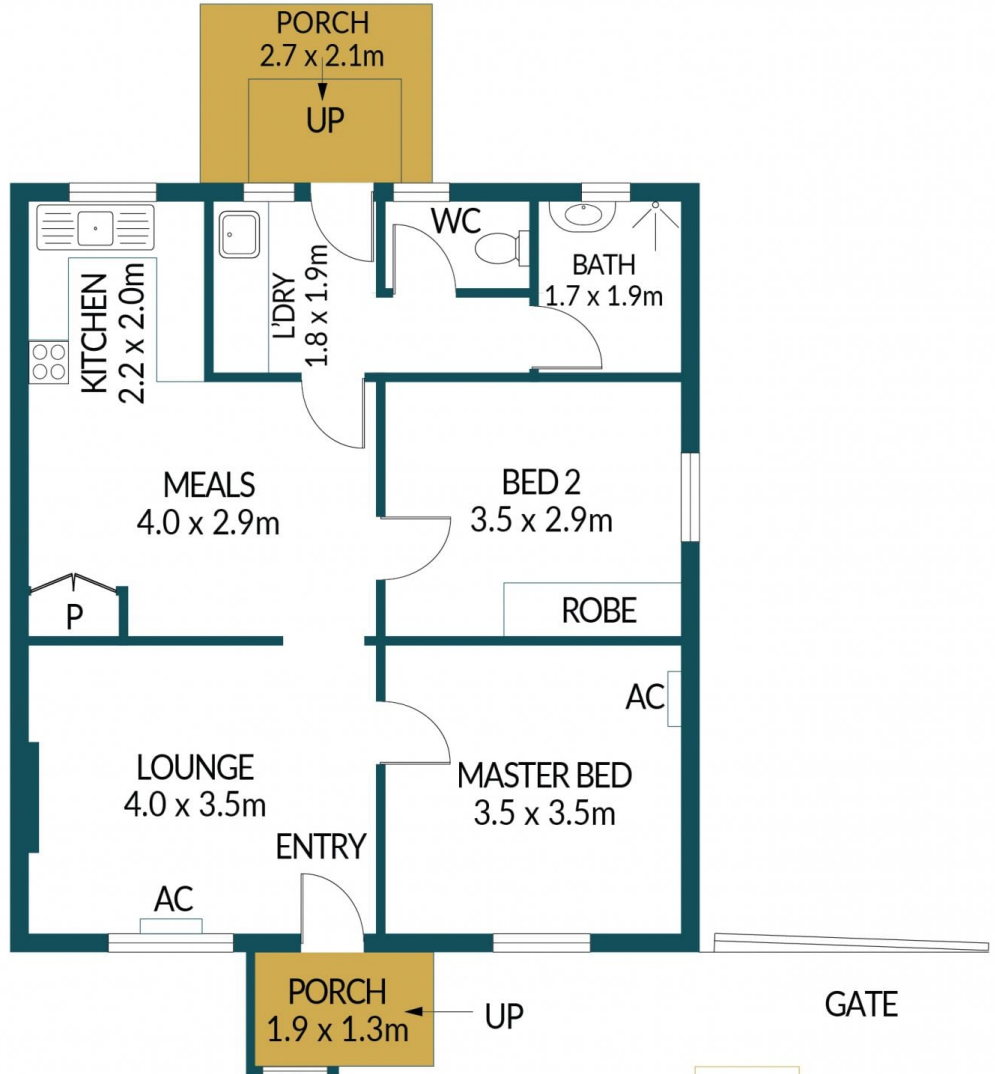
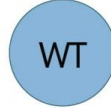
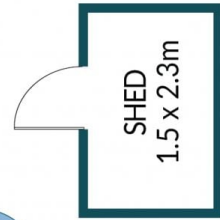
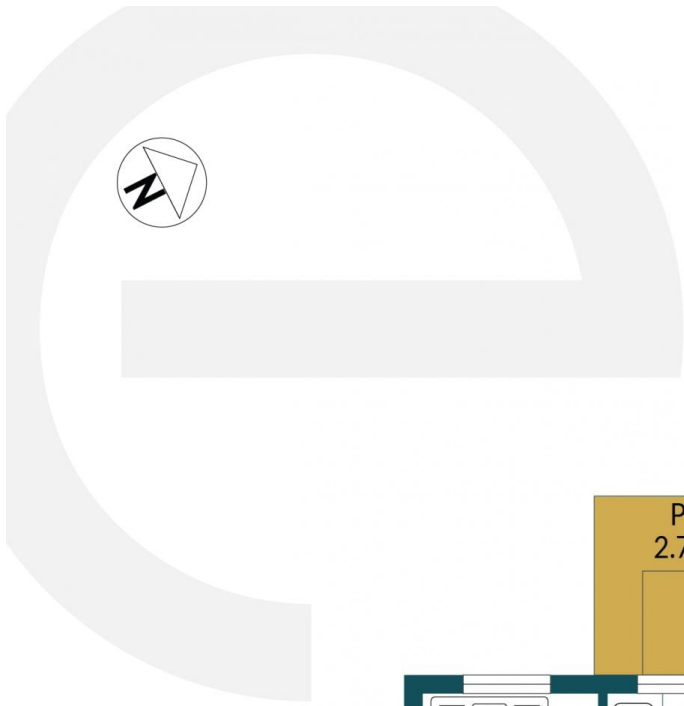

50 MAHOOD STREET, ELIZABETH GROVE



Disclaimer

Plans shown are for marketing purposes only. All dimensions and placements are approximate and not to scale. They are subject to errors and inaccuracies and Edge Realty will not accept any liability. Interested parties should make their own enquiries. Inclusions and exclusions must be confirmed in the Edge Realty Residential Contract.

APPROXIMATE DIMENSIONS

LIVING:	65.1m ²
SHED:	3.5m ²
PORCH/VERANDAH:	8.1m ²
TOTAL:	76.7m ²