



33 Kelsey Road SALISBURY NORTH SA

3 1 1

For an in-depth look at this home, please click on the 3D tour for a virtual walk-through or copy and paste this link into your browser

Virtual <https://my.matterport.com/show/?m=aeYVLRceqV7> Tour Link:

To submit an offer, please copy and paste this link into your browser:
<https://www.edgerealty.com.au/buying/make-an-offer/>

Mike Lao, Tyson Bennett and Edge Realty RLA256385 are proud to present to the market a solid brick maisonette set on a generous 521sqm (approx) allotment, offering a great opportunity to add value and make it your own. Suited to first home buyers, investors or downsizers, this home

[For full version visit the website](https://www.edgerealty.com.au)

Type : House
Price : \$499,000 - \$548,000
Building Size : 98 sqm
Land Size : 521 sqm
View : <https://www.edgerealty.com.au/sale/sa/north-north-east-suburbs/salisbury-north/residential/house/8685482>



Mike Lao
 0410 200 250



Tyson Bennett
 0427 464 007

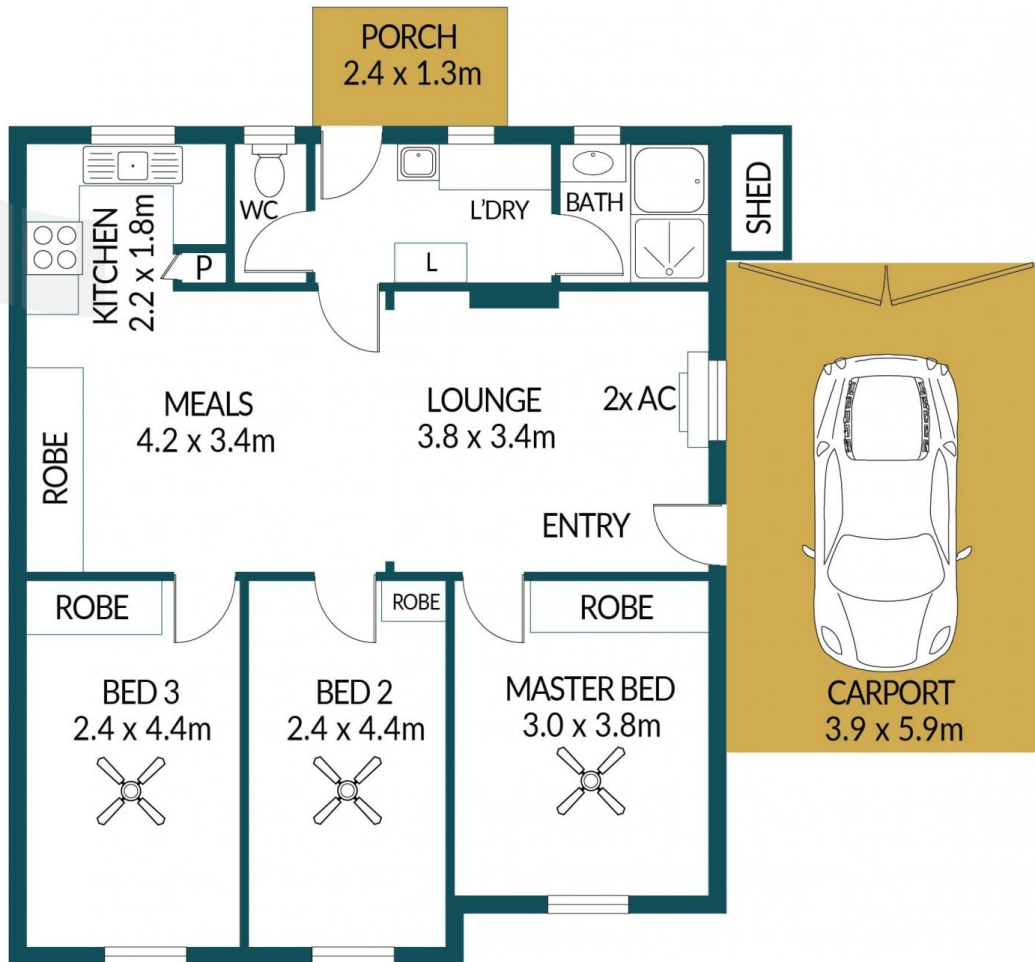

33 KELSEY ROAD, SALISBURY NORTH



Disclaimer

Plans shown are for marketing purposes only. All dimensions and placements are approximate and not to scale. They are subject to errors and inaccuracies and Edge Realty will not accept any liability. Interested parties should make their own enquiries. Inclusions and exclusions must be confirmed in the Edge Realty Residential Contract.

EDGEREALTY.COM.AU

APPROXIMATE DIMENSIONS

LIVING:	71.1m ²
CARPORT:	23.0m ²
SHED:	1.2m ²
PORCH:	3.1m ²
TOTAL:	98.4m ²