



## 59 Goodman Road ELIZABETH SOUTH SA

3 1 3

\*For an in-depth look at this home, please click on the 3D tour for a virtual walk-through or copy and paste this link into your browser\*

Virtual <https://my.matterport.com/show/?m=zQ3ivmCigj3> Tour Link:

To submit an offer, please copy and paste this link into your browser:  
<https://www.edgerealty.com.au/buying/make-an-offer/>

Mike Lao, Joshua Boyd and Edge Realty RLA256385 are proud to present to the market a neat and tidy three bedroom maisonette, recently transformed and ready for its next chapter. Set on a generous 536sqm (approx) allotment, this home offers an ideal opportunity set for

[For full version visit the website](https://www.edgerealty.com.au)

**Type** : House  
**Price** : \$549,000 - \$599,000  
**Building Size** : 240 sqm  
**Land Size** : 536 sqm  
**View** : <https://www.edgerealty.com.au/sale/sa/north-north-east-suburbs/elizabeth-south/residential/house/8690860>



**Mike Lao**  
0410 299 259



**Joshua Boyd**  
0497889178

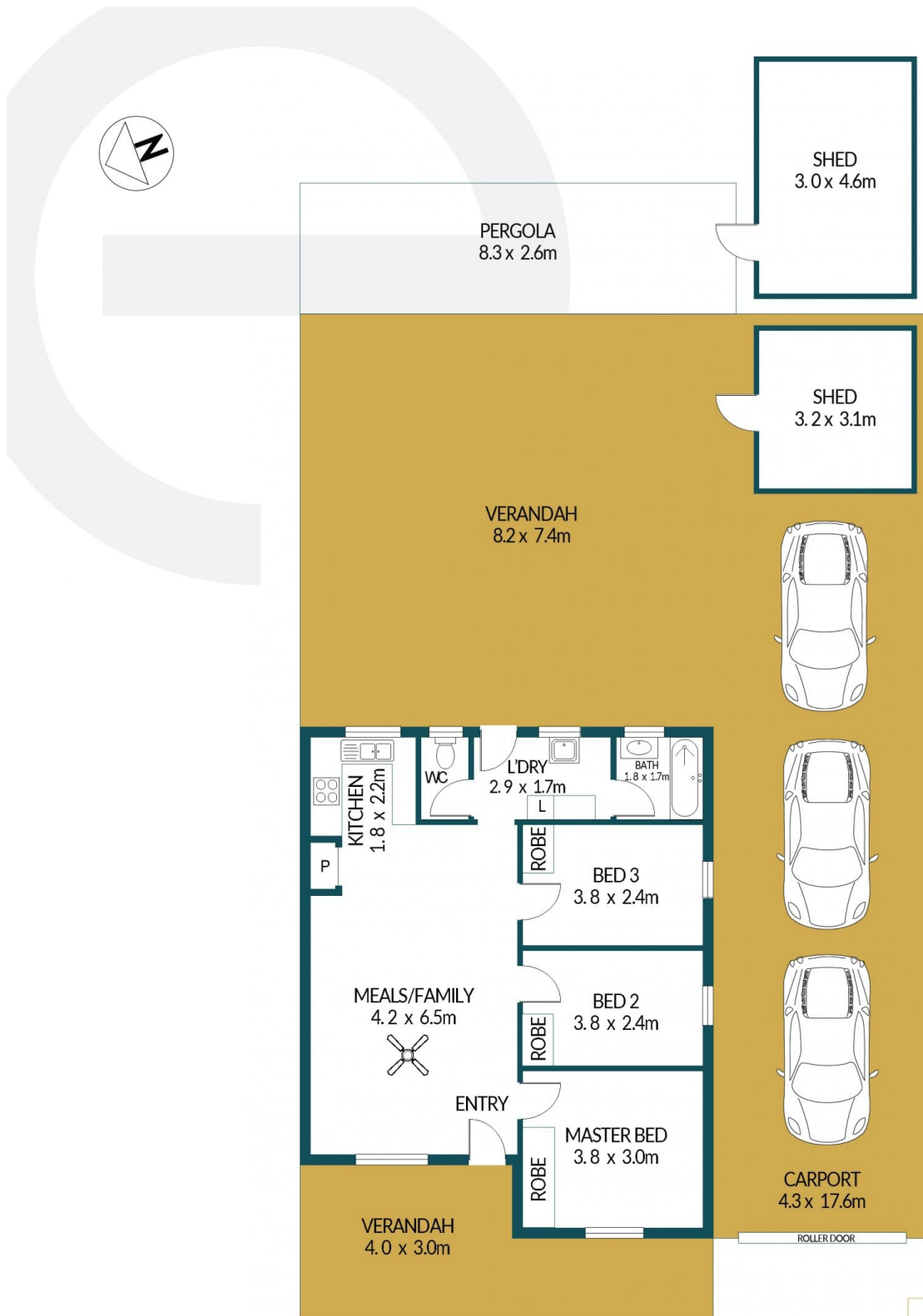

## 59 GOODMAN ROAD, ELIZABETH SOUTH



### Disclaimer

Plans shown are for marketing purposes only. All dimensions and placements are approximate and not to scale. They are subject to errors and inaccuracies and Edge Realty will not accept any liability. Interested parties should make their own enquiries. Inclusions and exclusions must be confirmed in the Edge Realty Residential Contract.

EDGEREALTY.COM.AU

### APPROXIMATE DIMENSIONS

LIVING:	70.4m <sup>2</sup>
VERANDAH/PERGOLA:	95.2m <sup>2</sup>
CARPORT/SHED:	98.6m <sup>2</sup>
TOTAL:	264.2m <sup>2</sup>