



41A Johnston Road ELIZABETH DOWNS SA

3 2 1

For an in-depth look at this home, please click on the 3D tour for a virtual walk-through or copy and paste this link into your browser

Virtual Tour Link:
<https://my.matterport.com/show/?m=gRVYTK1jRiT>

To submit an offer, please copy and paste this link into your browser:
<https://www.edgerealty.com.au/buying/make-an-offer/>

Mike Lao, Brendon Ly and Edge Realty RLA256385 are proud to present to the market a modern and low maintenance three bedroom home positioned on a 306sqm (approx) allotment and constructed by Loftly Building Group, offering an outstanding opportunity for first home

[For full version visit the website](https://www.edgerealty.com.au)

Type : House
Price : \$749,000 - \$799,000
Building Size : 169 sqm
Land Size : 306 sqm
View : <https://www.edgerealty.com.au/sale/sa/north-north-east-suburbs/elizabeth-downs/residential/house/8716874>



Mike Lao
 0410 299 259



Brendon Ly
 0417 988 444

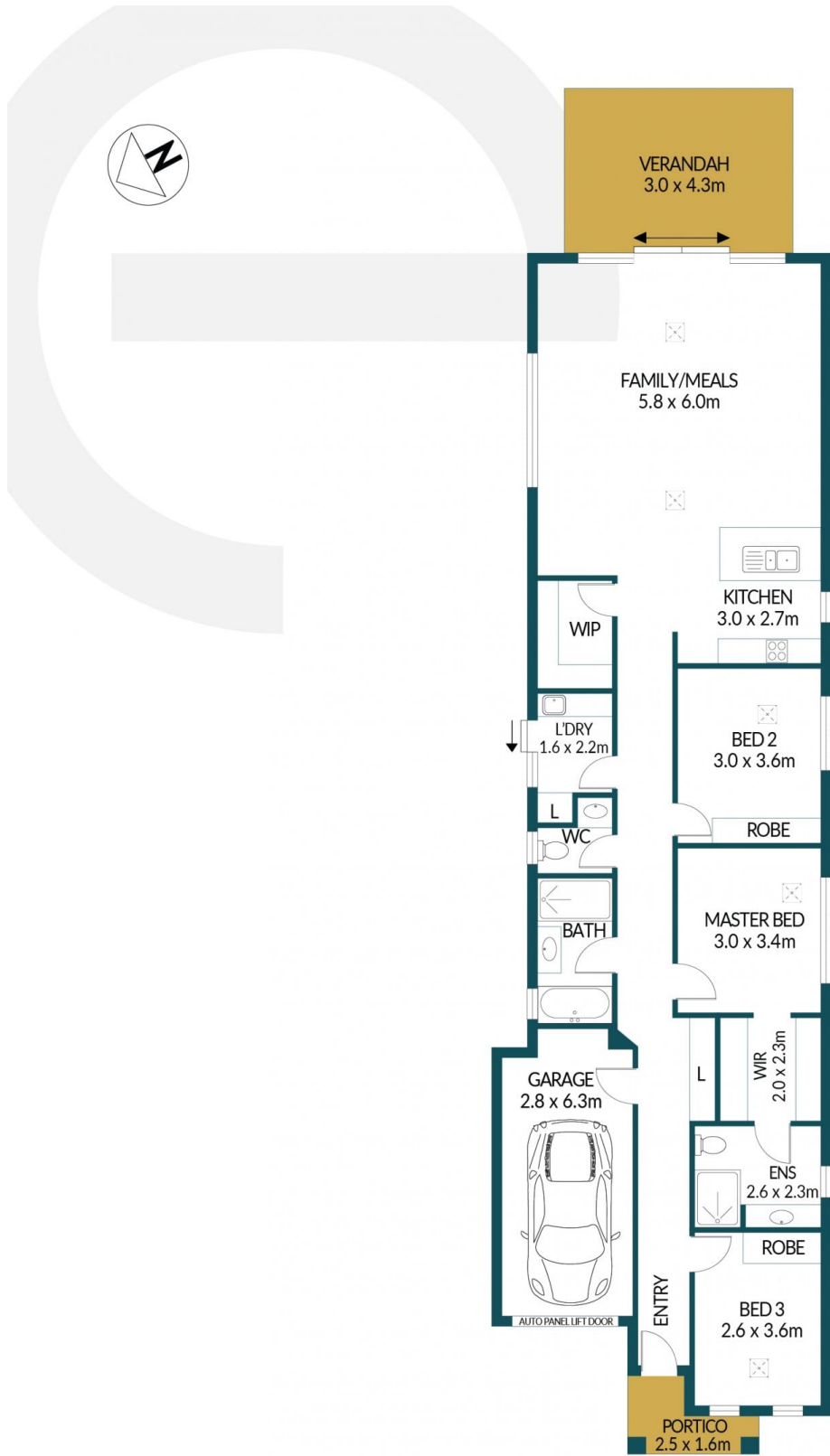

41A JOHNSTON ROAD, ELIZABETH DOWNS



Disclaimer

Plans shown are for marketing purposes only. All dimensions and placements are approximate and not to scale. They are subject to errors and inaccuracies and Edge Realty will not accept any liability. Interested parties should make their own enquiries. Inclusions and exclusions must be confirmed in the Edge Realty Residential Contract.

EDGEREALTY.COM.AU

APPROXIMATE DIMENSIONS

LIVING:	132.49m ²
GARAGE:	20.41m ²
PORTICO/VERANDAH:	16.47m ²
TOTAL:	169.37m ²